



Park Board Agenda
Monday, August 21, 2023, 7:00 p.m.
Kirkwood Community Center
111 South Geyer Rd.



CITIZEN COMMENTS *(See instructions on the previous page for offering a comment. The public comment portion of the meeting is an opportunity to hear comments from citizens. It is not a question and answer session and the Park Board will not respond to comments or answer questions during the comment period. The Chairperson may refer any matter to staff or hold discussion during the "Other Matters" section of the meeting).*

I. APPROVAL OF JUNE 26, 2023 MEETING MINUTES

II. COMMITTEE ASSIGNMENTS/REPORTS

- a. Alphonse Smith Memorial Update
- b. Implementation Committee Update

III. UNFINISHED BUSINESS

- a. Strategic Plan Update

IV. NEW BUSINESS

- a. Mitchell Park Master Plan
- b. Walker Park Fence
- c. Other Matters

V. SUPERINTENDENT OF PARKS, HEAD RANGER AND VOLUNTEER COORDINATOR REPORTS

VI. DIRECTOR'S REPORT

VII. BOARD MEMBER COMMENTS

VIII. ADJOURNMENT

Next Meeting – September 25, 2023

Staff Liaison: Kyle Henke. Phone: 314.822.5856 Email: henkek@kirkwoodmo.org

Chair: Ellen Edman

Accommodation: The City of Kirkwood is interested in effective communication for all persons. Persons requiring an accommodation to attend and participate in the meeting should contact the City Clerk at 314-822-5802 at least 48 hours before the meeting. With advance notice of seven calendar days, the City of Kirkwood will provide interpreter services at public meetings for languages other than English and for the hearing impaired. Upon request, the minutes from this meeting can be made available in an alternate format, such as a CD, by calling 314-822-5802.

From the desk of:
Kyle Henke, Director of Parks and Recreation
111 S. Geyer Road, Kirkwood, MO 63122
Phone: 314-822-5856 Fax: 314-984-5931
E-mail: henkekk@kirkwoodmo.org



Memo

To: Kirkwood Park Board
From: Kyle Henke
Date: August 16, 2023
Re: August 21, 2023 Agenda Memo

Committee Reports

Committee Reports – Alphonse Smith update – A member of the partnership committee or a staff person will provide an update regarding the event and plans for the plaque moving forward.

Implementation Committee Update – The Committee met on July 3 to review the Mitchel Park Master Plan process. Draft minutes from the committee meeting are included in the packet.

Unfinished Business

Strategic Planning Update – This represents the monthly opportunity to provide updates on any actions taken regarding the strategic plan.

New Business

Mitchel Park Master Plan - DG2 completed the final copy of the Mitchel Park Master Plan and it is included in the packet. As a reminder, the project was initiated when a private donor showed interest in improving several amenities at the park. As a small neighborhood park that has nearby neighbors, The Park Board felt it was appropriate to conduct a small park Master Plan with public input components. A St. Louis County Parks and Recreation Planning Grant was utilized to fund the majority of the Master Plan project. Now that the plan is complete and includes a cost estimate, it is

suggested the Park Board take action to approve the concepts of the plan as a whole.

Walker Park Fence - The packet contains a photo of a fence at Walker Park near the property line with an adjacent apartment building. The apartment manager contacted Curt regarding its condition. On the apartment side, a hazardous retaining wall exists with a slight drop. Aesthetically, the fence is in poor condition. The apartment manager is questioning fence ownership and maintenance. The board will hear from Curt regarding these concerns. In hopes, a discussion can generate a path forward.

Maintenance Report – This represents the portion of the meeting that includes staff reports from the Superintendent of Parks, Park Ranger and the Volunteer Coordinator and are included in the packet.

Director's Report – My report will include information on the following:

- Community Center Update
- Greentree Update
- Aquatic Center Update



**Park Board
Meeting Minutes
Monday, June 26, 2023, 7:00 p.m.
Kirkwood Community Center Room 202**



IN ATTENDANCE: The meeting was called to order at 7:02 p.m. with President Ellen Edman, Steve Ostrowski, Nate Wurtz, Jordan Wienke, Kathy Paulsen (absent), Christopher Molitor, Kevin Miller (absent), Lauren Nieman, Becky Jones and Staff Liaison Kyle Henke, Curt Carron and Pete Laufesweiler in attendance.

I. CITIZEN COMMENTS

Alan Hopefl, 12 Orchard Way, welcomed the new Park Board members and gave them advice on learning to be Park Board members.

II. APPROVAL OF MAY 15, 2023 MEETING MINUTES

A motion made by Chris Molitor to approve the May 15, 2023 meeting minutes, seconded by Nate Wurtz. Motion approved unanimously.

III. COMMITTEE REPORTS

- a. Committee Assignments – Ellen talked about current openings on committees and asked the Board members to review them and let her know what committees they would like to be on.
- b. Partnership Committee – Update on memorial applications and Quinette cemetery repairs.
- c. Foundation Committee – Founding members, Steve Coates, Meredith Byers and Linda Ross will be taking over soon and the foundation committee will end.

IV. UNFINISHED BUSINESS

- a. Strategic Goals Update – Ellen discussed progress on strategic goals.

V. NEW BUSINESS

- a. Vehicle Purchases

A motion made by Jordan Wienke to approve a transfer of \$2,388 from the Park Fund balance to 201-09-100-101-000-620040 for the purchase of park maintenance vehicles and equipment. Seconded by Nate Wurtz. Motion approved unanimously.

A motion made by Nate Wurtz to approve the purchase of a ¾ ton and ½ ton truck from Don Brown Chevrolet with an aftermarket liftgate from Knapheide truck equipment for a total cost of \$84,388. Seconded by Jordan Wienke. Motion approved unanimously.

- b. Walker Park Playground Surface

A motion made by Jordan Wienke to appropriate an additional \$4149 from the Park Fund balance to 201-09-100-000-620030. Seconded by Becky Jones. Motion approved unanimously.

A motion made by Christopher Molitor to enter into a contract with Gametime c/o Cunningham Recreation for the not to exceed amount of \$17,149 to replace the



poured in place playground surface at Walker Park. Seconded by Nate Wurtz. Motion approved unanimously.

VI. SUPERINTENDENT OF PARKS REPORT

- a. Curt discussed the Superintendent of Parks' report.

VII. DIRECTORS REPORT

- a. Mitchell Park – Second public input session was held.
- b. I44 bridge overpass - Grand opening event was held June 24 10am – 11:30am, well attended.

VIII. BOARD COMMENTS

None

IX. ADJOURNMENT – The meeting was adjourned at 7:39 p.m.

DRAFT

Park Board implementation Committee Minutes - July 3, 2023

Attendance: Lauren Neiman, Nate Wurtz, Steve Ostrowski

Staff: Kyle Henke

The meeting convened at 3:00 p.m. at the Kirkwood Community Center, Rm. 202

- I. No Citizen Comments:
- II. No minutes to approve
- III. No Unfinished business
- IV. New business
 - a. The committee reviewed public session input and the survey using the draft of the Mitchell Park Master Plan.
 - b. The Committee was presented with the proposed design and agreed that all elements requested by the public were included.
 - c. The committee discussed moving forward and that we are on the right track. A comment was made to keep the donors request for a larger shaded area in mind for the final construction documents and plan moving forward.
 - d. Kyle indicated the final Master Plan document will be submitted by DG2 soon and will include cost estimates. The plan will be shared with the Park Board for approval at the next meeting.

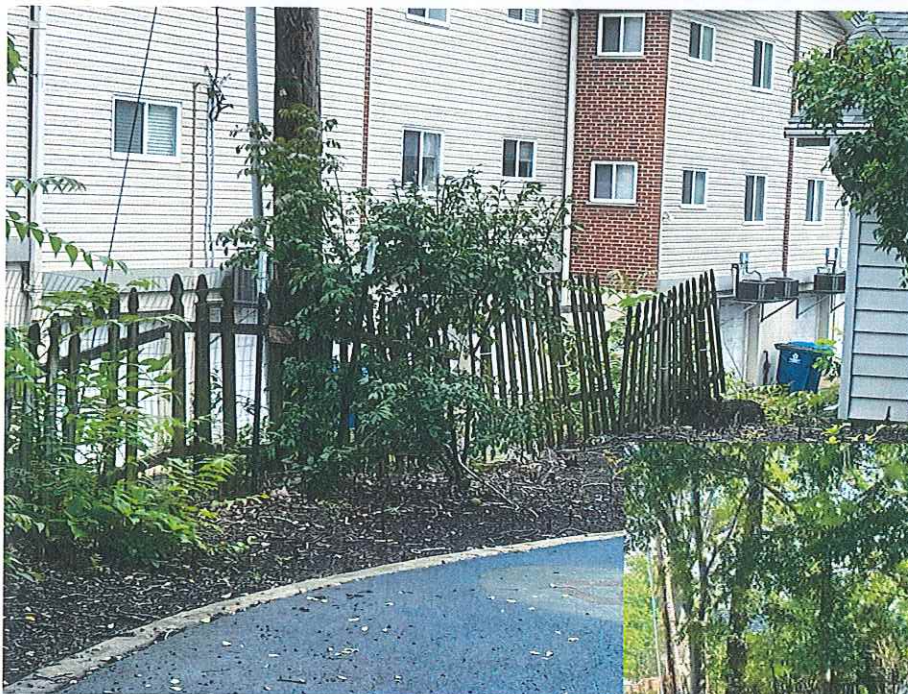

MAINTENANCE REPORT FOR JULY/AUGUST 2023

For period June 21 through August 13

JULY 4 FIREWORKS:

This year's fireworks display went off very smoothly, including historical weather concerns. Between the heat, drought and last minute plentiful rains prior to the event the evening was perfect for viewing the display. Dave and Pete ran the event start to finish, this being the first in 45 years that it was run by others. All preparations were like clockwork, and the well-attended event was cleaned up by midnight.

WEATHER EVENTS:

This long span between meetings saw a number of torrential downpours, high winds and even a little hail. Crews spent about a cumulative week cleaning downed limbs, shredded trees and deadwood cleanup. We were fortunate what would be expected to fall or blow apart did in fact spare much healthier trees, and those weaker trees/limbs would have come down sooner than later anyway. It gave a couple of our new FT hires the opportunity to practice on some storm damage using the aerial truck, a first for both Kyle and James.

ASPHALT PREP WORK AT QUARRY ROAD:

We identified areas that need to be cut and patched along the edge of the quarry roadway. All those cuts were filled back in and rolled. This amounted to about 4 tons of hot mix, laid in advance of the milling and paving operation yet to come this season. The entire length of the quarry roadway will be re-paved yet this late summer to maintain stability and create a safer surface for park users.

DRINKING FOUNTAIN RESTORED:

The drinking fountain located in the brick memorial plaza in Kirkwood Park is scheduled to be sandblasted, primed and electro-painted the week of Aug 21. This process features a paint process that adheres paint using an electrical charge to the target. It takes the place of the manufacturer's powder coating when the finish fails.

PAINTING ELSEWHERE IN KIRKWOOD PARK:

Another contract has been awarded for painting of the 3 exterior walls of the handball courts. The original coating has become chalky and faded. It will be prepped by power washing, and painted. This only involves the exterior concrete walls. Upon completion, the same contractor will move his operation to ball diamonds 5&6. There the light poles for both fields will be prepped and painted from below the lamp fixtures to the ground. The contractor will bring in a 70ft lift that rolls from pole to pole, applying paint to all 10 poles. This is also scheduled for the week of August 21.

TREE TO BE REMOVED IN PLAYGROUND:

The American Elm that has provided shade to the playground area for well over 70 years must be removed. It has developed structural cavities and fruiting bodies have begun to establish, making it a high risk tree. The tree survived Dutch Elm disease, and was bolstered with injections over the years. We got as much out of it as we could, but the old adage goes, "once you know something is wrong, you have to act". We will begin piecing it out the week of August 21 after camps have ended for the summer. Pete has provided this brief synopsis leading up to this decision.

The American Elm located along the walk by the playground in Kirkwood Park has been in decline for the past few years. Annually we have been removing deadwood to mitigate the risk to park patrons, but this year we noted that the tree was exhibiting signs that indicated internal decay. Upon further inspection a significant cavity was found in the central stem at approximately 30' high. Using the ISA Tree Risk Assessment method Pete determined that the tree had a high risk associated with it and sought a second opinion from Trees, Forests, and Landscapes Master Arborist Michael Sestric to confirm the assessment. He confirmed the assessment and recommended removal due to the safety risk associated with the tree and its proximity to the walk and playground.

Services	Jan	Feb	March	April	May	June	July	August	Sept	Oct	Nov	Dec	YTD
Park Enf. Contacts	25	17	31	45	61	52							231
Public Contacts	165	102	153	164	155	142							881
PD Assist	6	2	2	3	5	1							19
PD Dispatched Calls	1	2	1	4	4	2							14
Interpretive	0	0	0	16	55	0							71
Reported Maint.	5	3	2	4	3	2							19
Injuries	1	0	0	0	1	1							3
Wildlife Related	2	0	1	1	0	0							4
Recovered Property	3	2	4	5	6	5							25
First Aid	0	0	1	2	1	2							0
Missing Persons	0	0	0	0	0	0							0
Training Hours	10	16	16	48	6	0							96

Summary of Activities

- In late June, employment offers were made to Roger Smith and Adam Lopez. They have started training in July and will offer some needed relief to the monthly schedule.

Prepared by: Senior Ranger Ron Hall

Services	Jan	Feb	March	April	May	June	July	August	Sept	Oct	Nov	Dec	YTD
Park Enf. Contacts	25	17	31	45	61	52	65						296
Public Contacts	165	102	153	164	155	142	145						1026
PD Assist	6	2	2	3	5	1	4						23
PD Dispatched Calls	1	2	1	4	4	2	3						17
Interpretive	0	0	0	16	55	0	0						71
Reported Maint.	5	3	2	4	3	2	4						23
Injuries	1	0	0	0	1	1	0						3
Wildlife Related	2	0	1	1	0	0	1						5
Recovered Property	3	2	4	5	6	5	6						31
First Aid	0	0	1	2	1	2	0						0
Missing Persons	0	0	0	0	0	0	0						0
Training Hours	10	16	16	48	6	0	0						96

Summary of Activities

-Rangers logged 47.25 hours setting up, working the event and tear down for the July 4th Freedom Festival.

-Another part time ranger was added to the roster, Dan Bailey started training in late July.

Prepared by: Senior Ranger Ron Hall

Monthly Volunteer Activity Report



June | 2023

Volunteer Hours

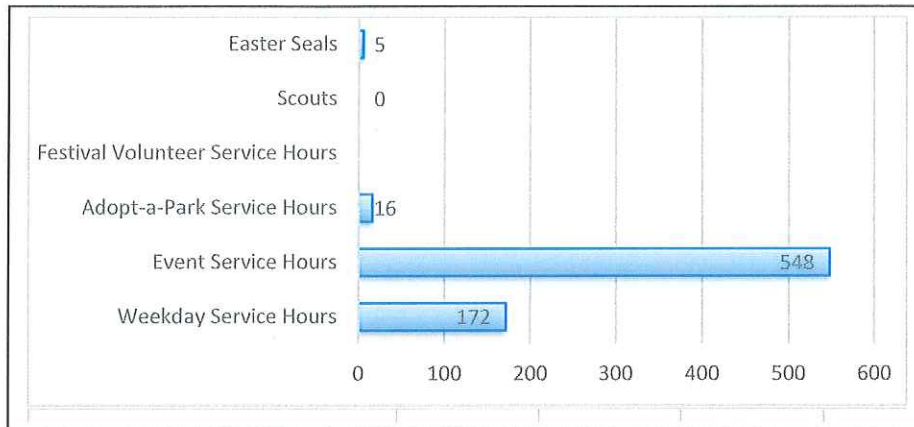

Upcoming Events

July 8: Honeysuckle Project in Quarry Park

July 29: Weeding in the Aquatic Center



1,754
YTD Service Hours



260
YTD Volunteers



13
Weekday Volunteers



7
Events

Highlights

Camp Fuge spent several days during their two summer sessions volunteering with Kirkwood Parks. The group weeded and mulched the Historic Quinette Cemetery followed by weeding and mulching most of Kirkwood Park. The 30-member group put in 450 hours in June. The Ice Rink kindly donated two hours of free skate time for our appreciation of all their hard work.

The Historic Quinette Cemetery hosted its first tour presented by Keith Rawlings and Youth in Action for the Chamber of Commerce. Nearly 15 visitors walked the grounds and participated in walking tours by Youth in Action volunteers. Several people stayed and talked about 'old' Kirkwood. A number of visitors commented about the recent upkeep and volunteer efforts to maintain the cemetery grounds.

Monthly Volunteer Activity Report

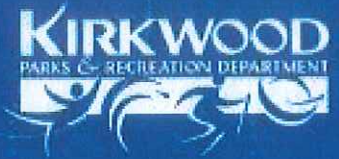

July | 2023

Volunteer Hours



Upcoming Events

Sept 15-17: Greentree Festival



1,960
YTD Service Hours



263
YTD Volunteers



13
Weekday Volunteers



2
Events

Highlights

This month, the volunteer program switched from conservation efforts on Saturday mornings to weeding the Aquatic Center. Volunteers received numerous complements on the landscaping and our efforts to maintain the beds. A few 'River Walkers' also joined in to weed along the lazy river!

The fall volunteer event calendar will be published soon.

Recruitment for the Kirkwood Greentree Festival is underway.

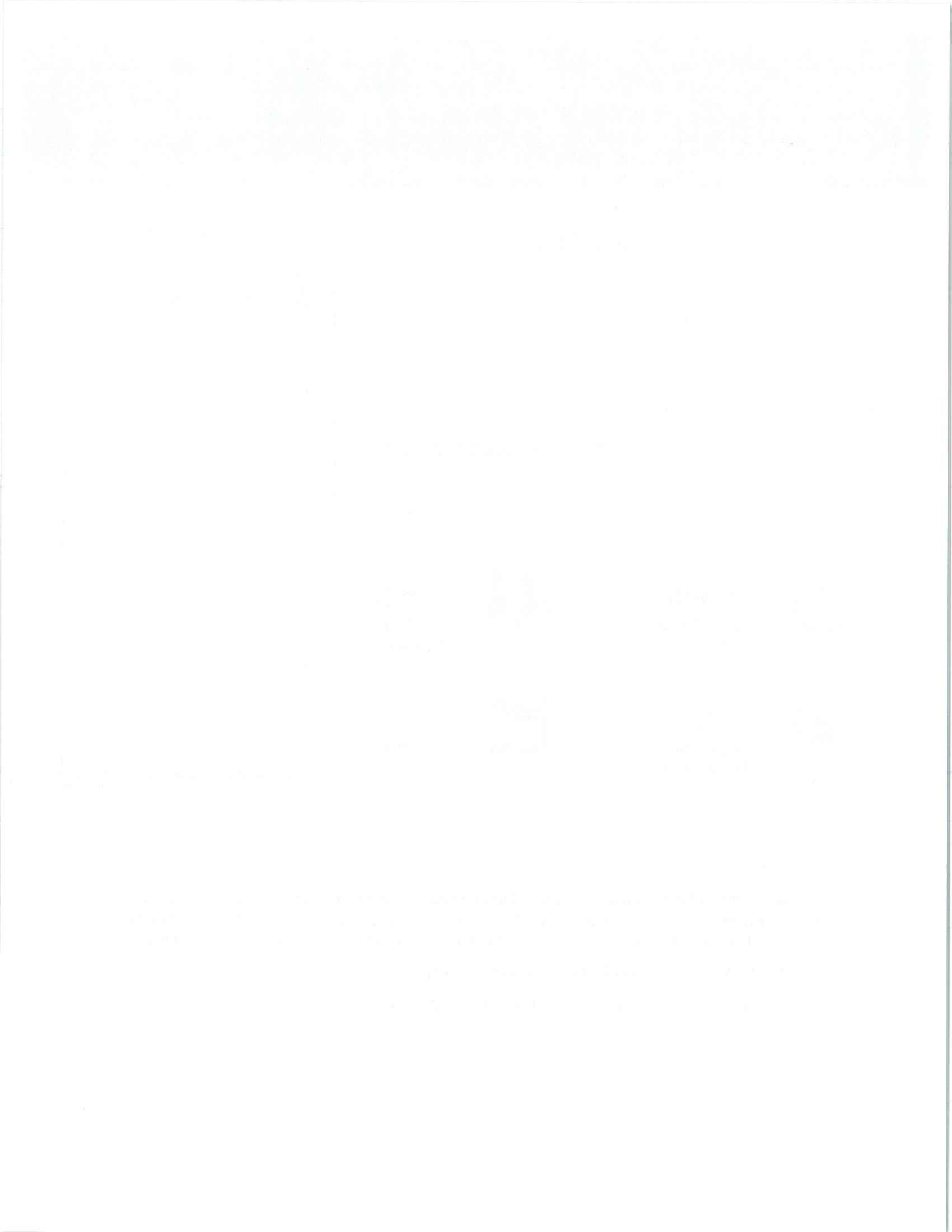

CITY OF KIRKWOOD

Mitchell Park Master Plan

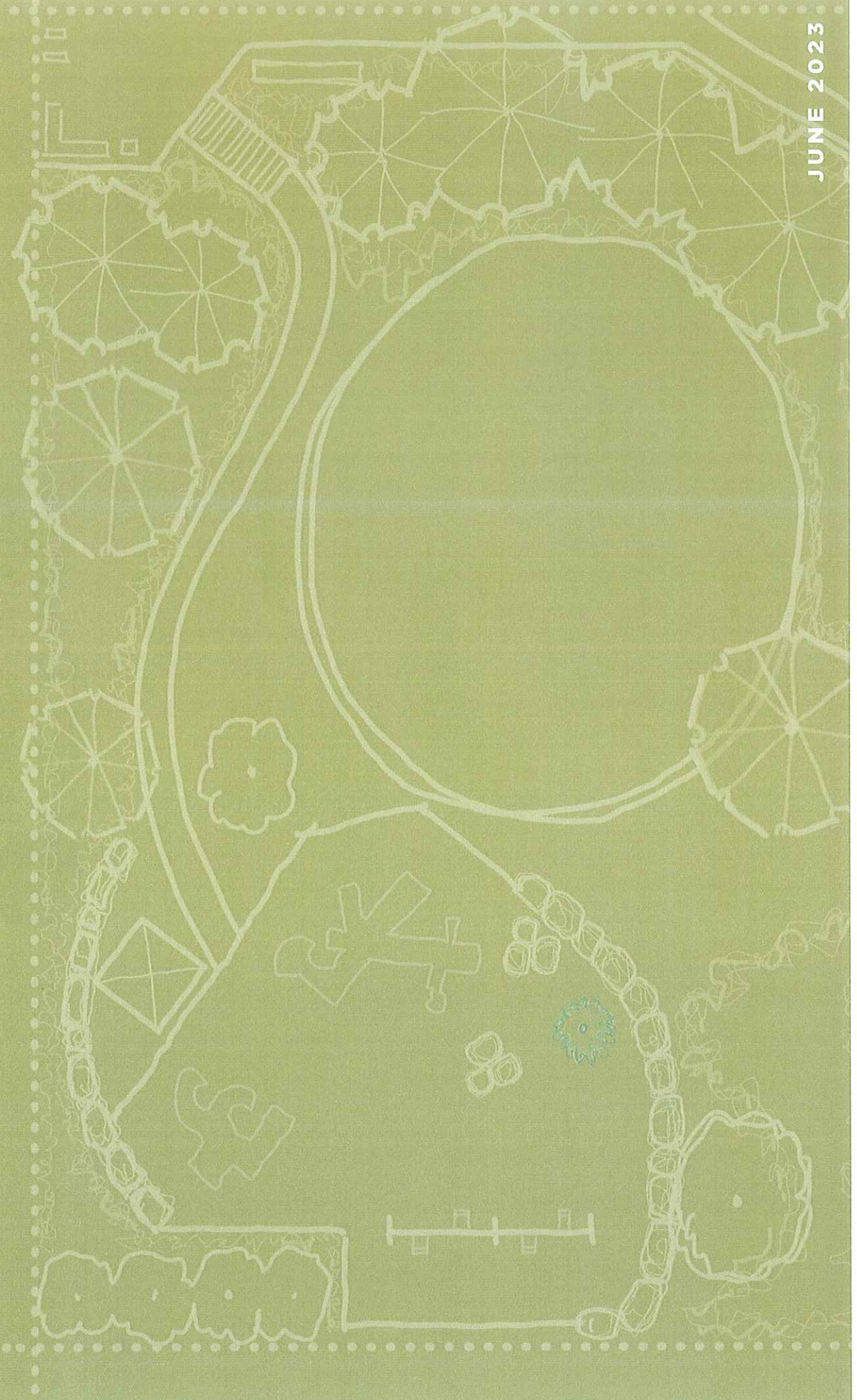

JUNE 2023



4835 MO-109, Suite 102 | Eureka, MO 63025
636-549-9007 | dg2design.com

Table of Contents

Existing Conditions & Site Analysis.....	4
Goals & Objectives.....	8
Preliminary Concept Option A.....	10
Preliminary Concept Option B.....	12
Community Engagement.....	14
Final Concept Plan.....	18
Appendices	
Cost Analysis.....	22
Community Feedback.....	24

Existing Conditions & Site Analysis

Mitchell Park is a small-scale, inviting and intimate park located in close proximity to the eastern city boundary. The park is well loved by neighbors, city residents, and dog walkers, who are attracted by the park's simple yet inviting layout with active and passive zones for use and relaxation.

The park is hugged by a mature tree canopy that provides shade as well as a sense of enclosure from the street and adjacent neighboring homes. Some of these mature trees are beginning to show signs of decline. An important goal for future improvement will be to assess and replace declining trees to ensure a sustained tree cover for the next few decades.

At the entry the park has a small arrival area with the park sign, a tiny-library and a bench. These elements are well used by park visitors.

The park has a gentle slope from north to south. Increased stormwater discharge into the park (along the north border) have heightened drainage issues across the site, specially on the central lawn and play equipment surface. Proposed improvements must address drainage issues to ensure the long-term lifespan of park amenities and structures.

The park is structured around a central lawn area. This flex space is well used by visitors of all ages. Activities in the lawn range from frisbee to fetch-the-ball, but also for passive activities and celebrations. The main goal for the open central space will be to improve its grading and drainage to prevent soggy spots.

On the west side, the park has two play structures for young kids, swings, a drinking fountain, a picnic table and benches. The two main structures will remain in place (as-is). The other elements will be upgraded based on the priorities identified through community input.



Existing entrance

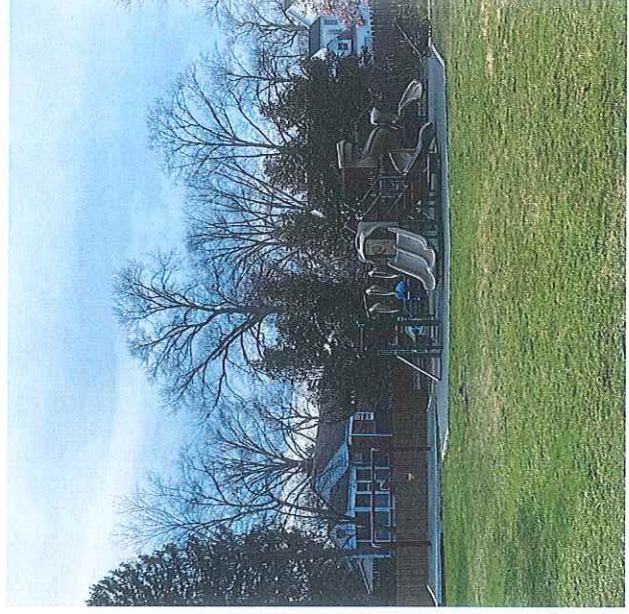

Existing playground to remain with modifications

Legend

- 1 Existing bench and library to remain
- 2 Existing trees to remove
- 3 Existing trees to remain
- 4 Existing lawn
- 5 Drainage issues
- 6 Existing playground to remain
- 7 Existing water access
- 8 Existing street light

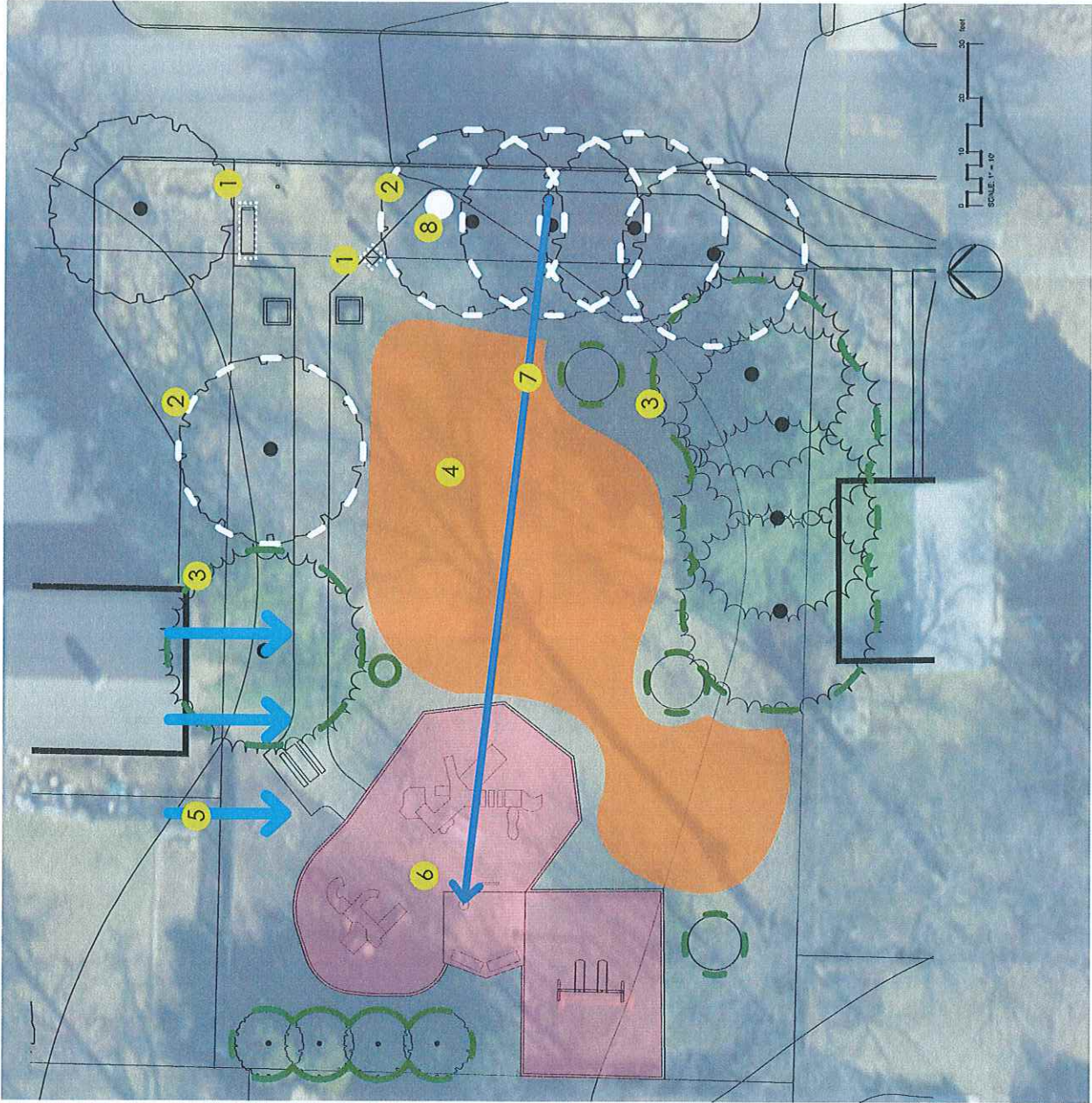

Existing Conditions Diagram



Park sign

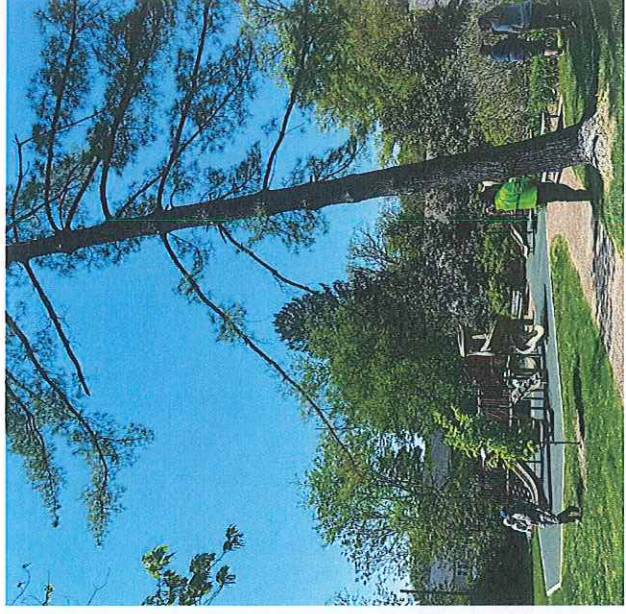

Potential tree removal

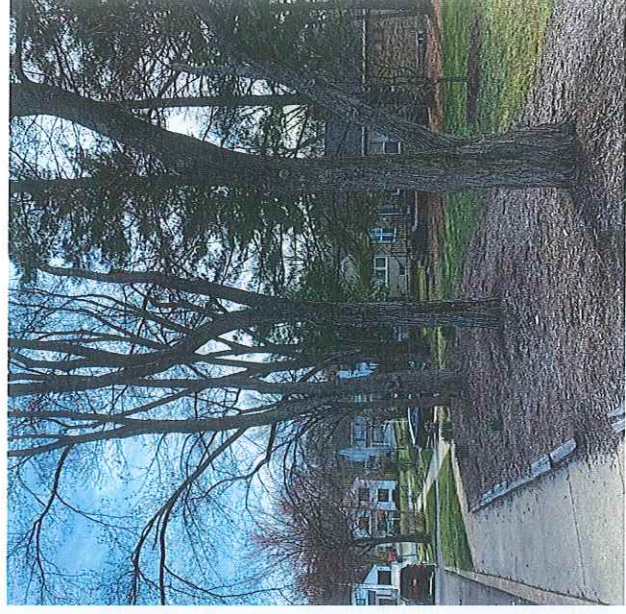

Potential tree removal along sidewalk

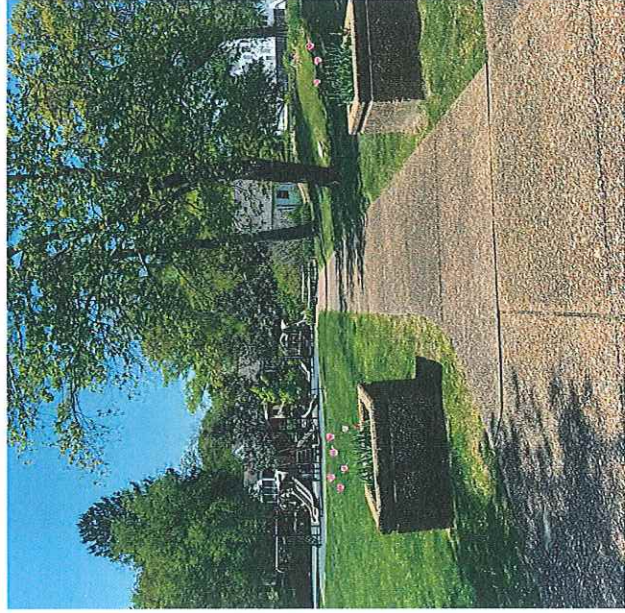

Entry path

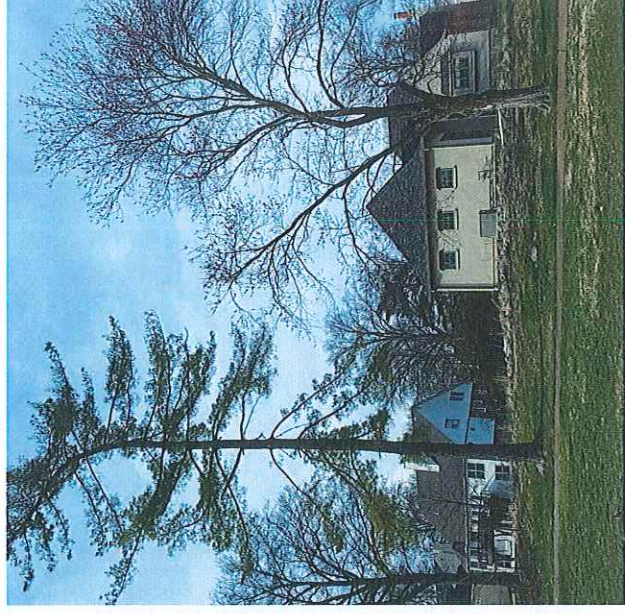

Sloping ground draining towards the park

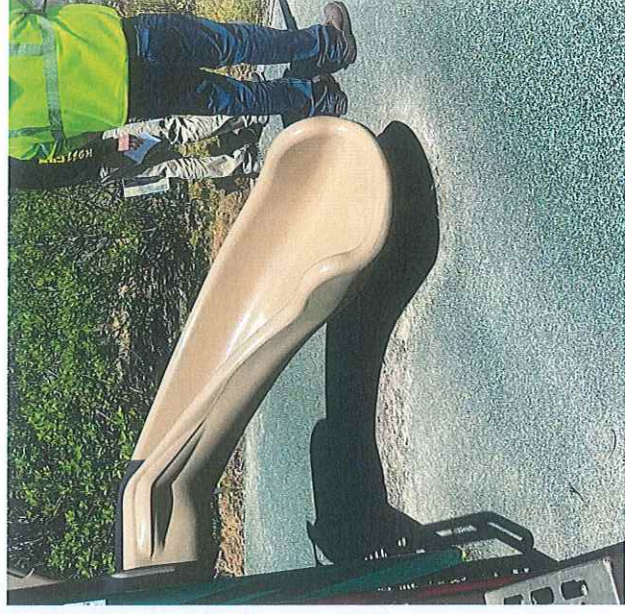

Rubber surface showing water damage



Site Analysis Diagram

Goals & Objectives

Through community outreach efforts including an online survey and two public meetings, as well as dialog with stakeholders and city staff, we have identified the following key goals and objectives for park improvements.

IMPROVE ADA ACCESS

Proposed improvements and amenities will be designed to satisfy ADA requirements and regulations to achieve an equitable and accessible recreational environment for all users.



ADDRESS DRAINAGE ISSUES

One of the main concerns identified by community members and stakeholders are issues related to park drainage. This is a primary concern that must be integrally resolved in coordination with other park improvements. The natural grade will have to be sculpted to convey water towards the street and/or low-spots with rain garden installations so that stormwater does not collect in areas for active use.



MAINTAIN PARK CHARACTER

Community members expressed the desire to keep the overall character of Mitchell Park intact including a central open lawn, lush canopy, an intimate and quiet feel, a great balance between active and passive engagement opportunities.

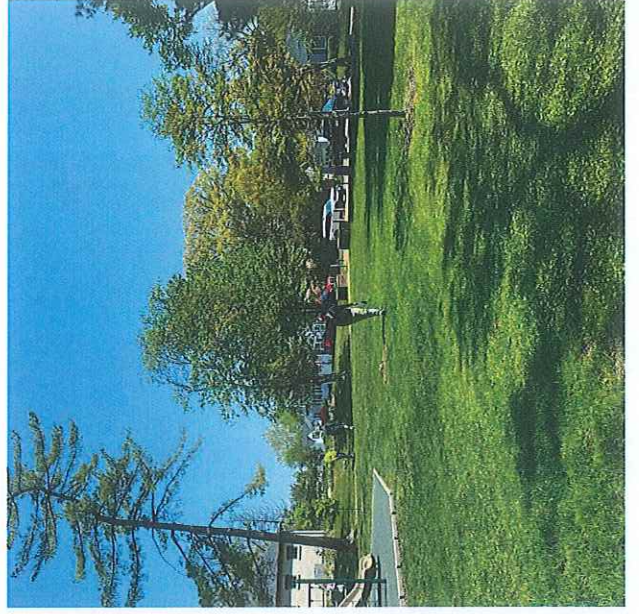

INCREASE PLAY OPPORTUNITIES

Parents and kids expressed the desire to see more opportunities for formal play with swings, but also informal play with landscape elements for climbing and skipping for example. Mitchell Park presents a great opportunity to include both with minimal tweaks to the current play area.

INCLUDE SMALL WATER PLAY

A small-footprint mist element will be a fun new addition to the park to cool and engage kids on warm days.

PROVIDE HABITAT & EDUCATION OPPORTUNITIES

Landscape improvements will present a great opportunity to integrate plantings that attract pollinators, show seasonality and/or other interesting characteristics; these features will become educational opportunities to highlight.

PROVIDE SHADE & A HEALTHY CANOPY

To ensure the long-term vitality of the tree canopy at Mitchell Park, a careful assessment of tree health will be performed. Declining trees will be replaced; performing trees will be preserved.

PRESERVE THE CENTRAL OPEN SPACE

The central open lawn is well used and liked by park visitors. Improvements to grading and drainage will result on a less-soggy lawn that encourages use throughout the year.

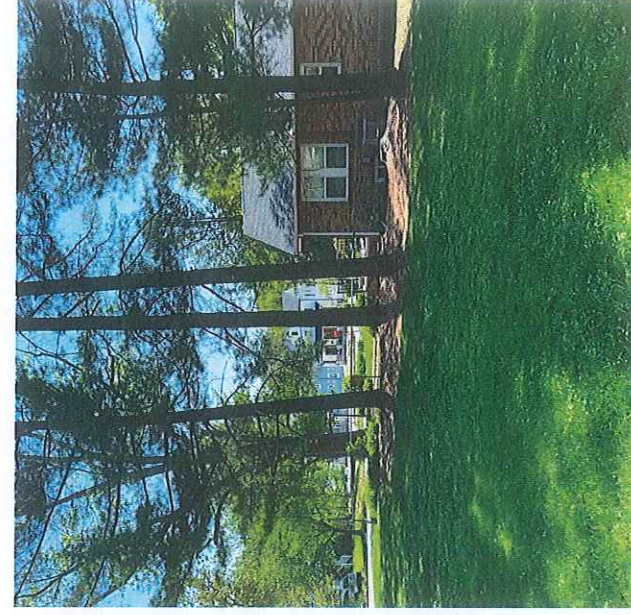
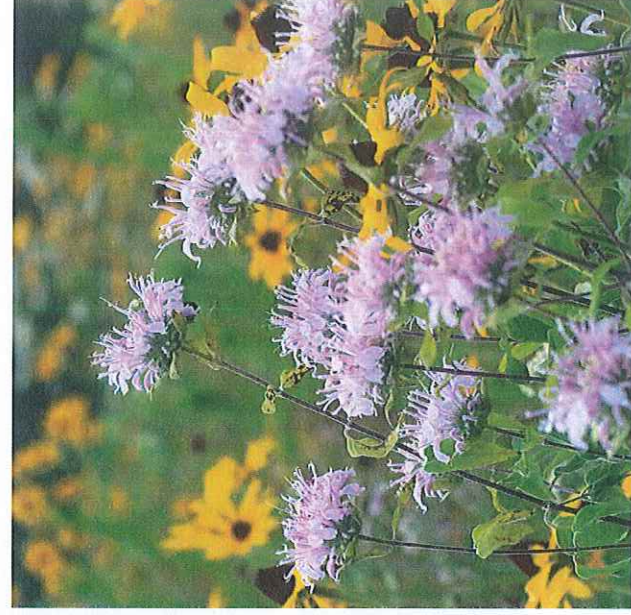
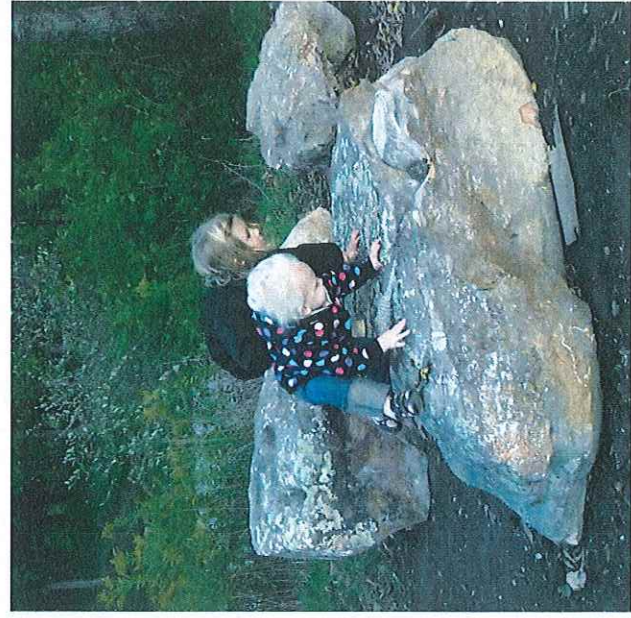

Preliminary Concepts

During the initial round of community engagement, the design team presented two configurations for park improvements, Options A and B.

Concept Option A, in this page, introduces a second entry path into the park and places play elements (swings and water play) in a more prominent, central location. A shade structure is located along the street edge in near proximity to other proposed improvements such as new signage and bike rack. An open lawn area stretches along the south and east boundaries. Rain gardens are introduced along the north boundary to address drainage.

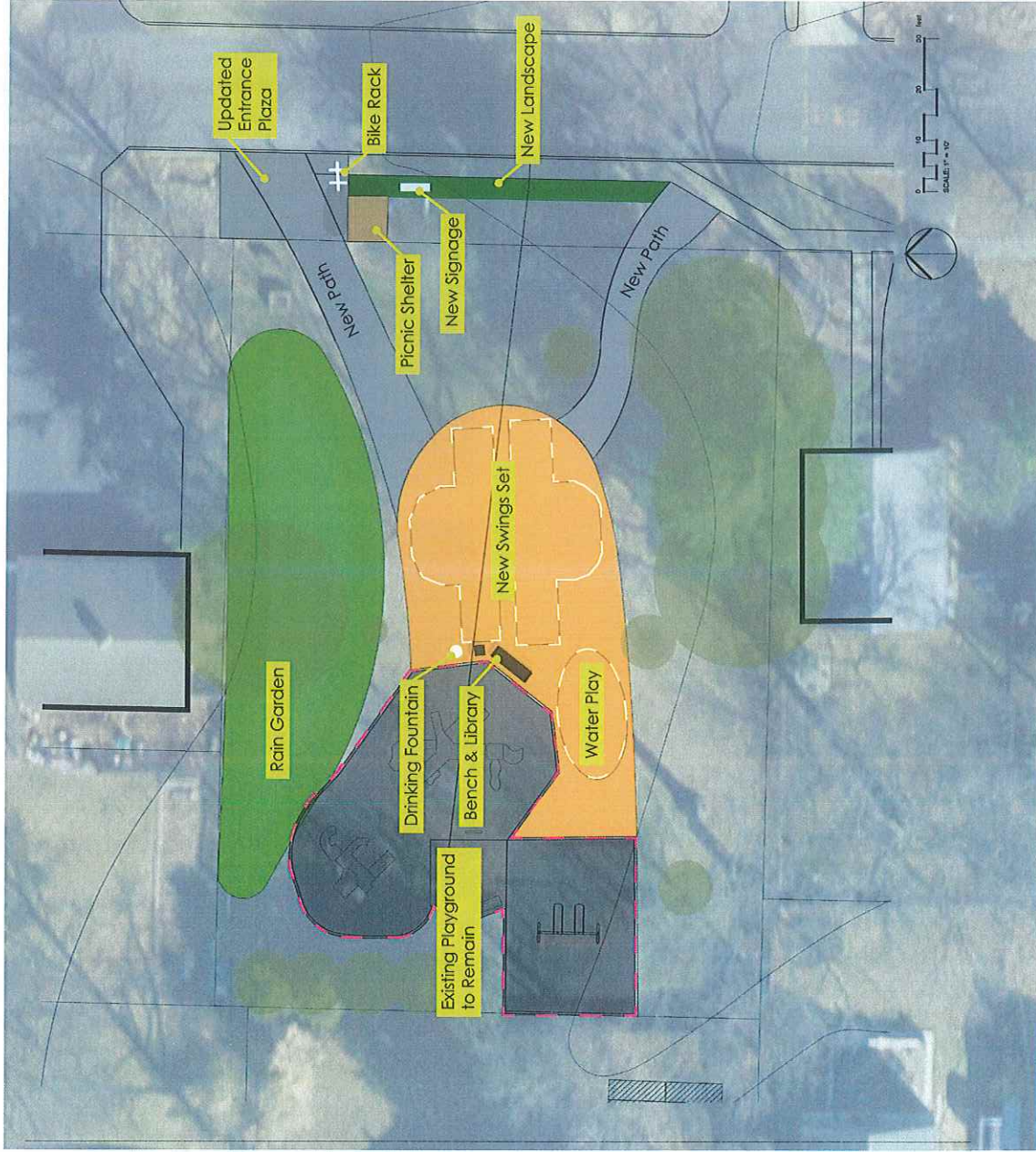

Concept Option A Diagram



Water Odyssey- Cool Stick



Water Odyssey- Curvy Cool

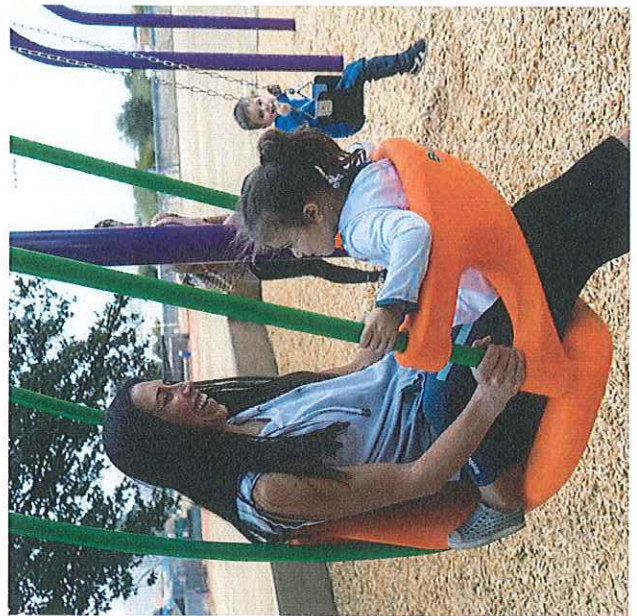

Bruke- Konnection Swing Seat

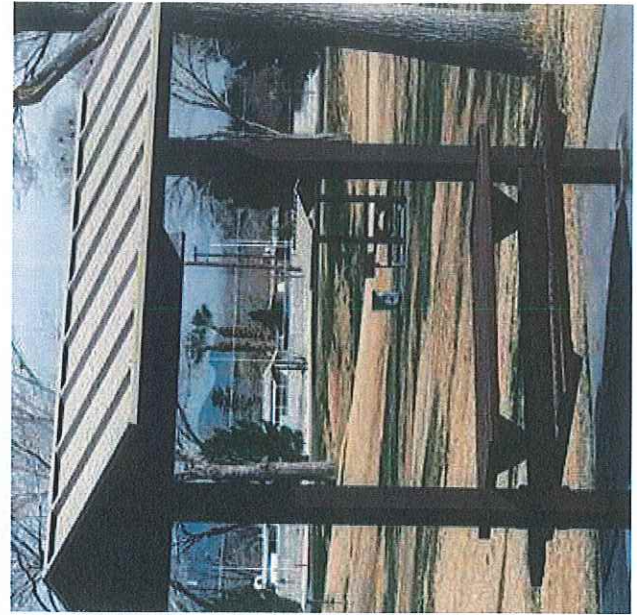

Polligon- Gable Roof Sunshelter

Concept Option B, in this page, preserves the single entry configuration and places new play equipment next to existing structures. An open lawn area remains close to the street edge and to the south. Rain gardens are introduced along the north boundary to address drainage.

Community input from these concepts (page 14 and appendix B) was synthesized and incorporated to create the final concept plan (page 18).



Concept Option B Diagram



Water Odyssey- Mission Hill Mister



Native Prairie



Landscape Structures- Friendship Swing



Polygon- Gable Roof Sunshelter



Rain Garden

Community Engagement

Feedback regarding park improvements was collected from community members through multiple channels.

In March of 2023, Community Meeting #1 was held virtually to solicit feedback on the two conceptual options for the park (Option A page 10 and Option B page 12).

This first meeting was followed by an online survey. Results from the questions included on the survey are shown in this and the following page. Most recommendations made by community members for what amenities to include were synthesized and incorporated into developing the final Concept Plan.

Some recommendations or preferences were not incorporated into the final concept due to excessive cost, conflicting uses with existing ones, large scale or footprint, and/or due to possible impacts to overall character. The elements that fall into this category include climbing walls, major climbing structure, musical or sound play, slides (existing) and spinners.

An Open House was held at the park in June 2023 to present the final Concept Plan to community members. The meeting was well attended and feedback was positive regarding the proposed improvements. Images from the event are shown on pages 16 and 17.

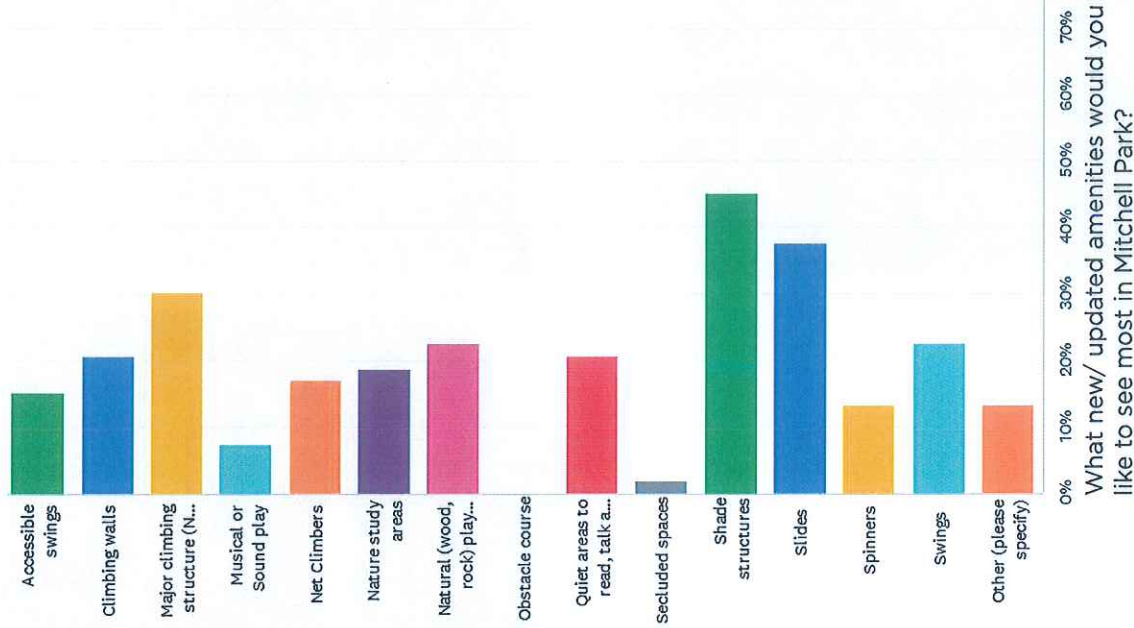

What new/ updated amenities would you like to see most in Mitchell Park?

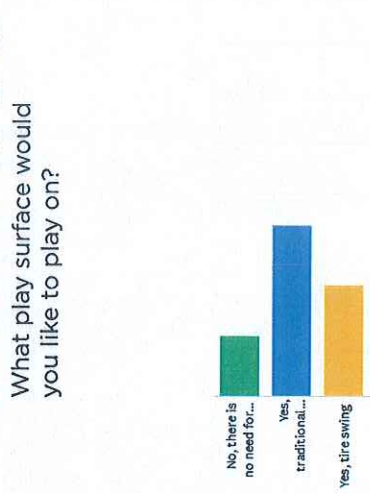
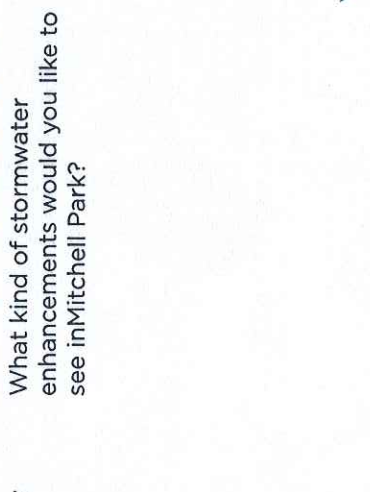
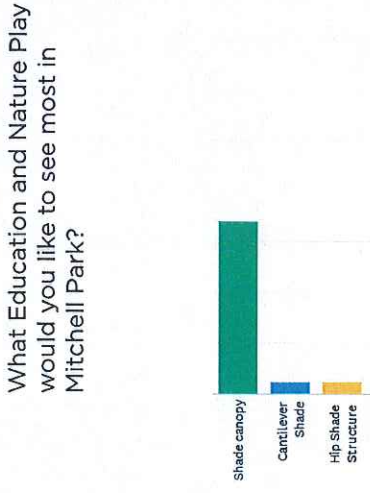
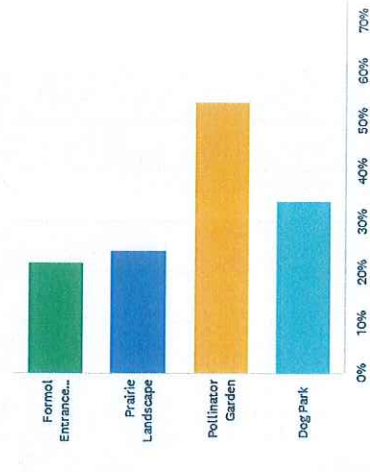
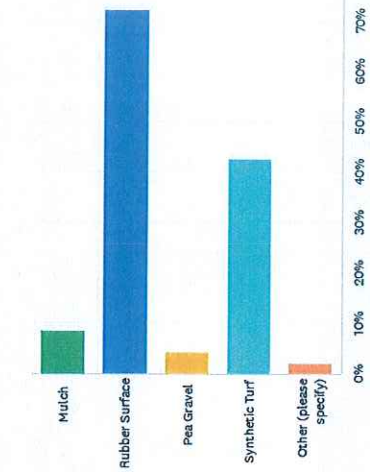
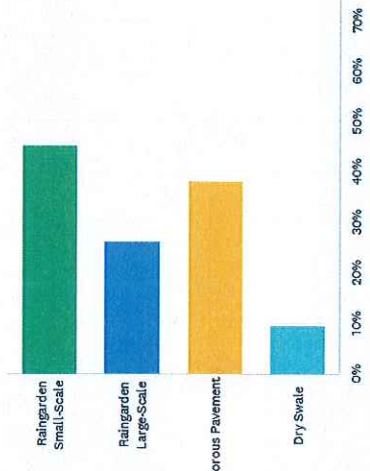
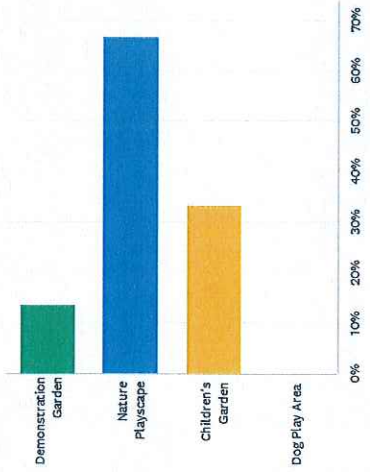

Survey Questions



Open House



Open House

Final Concept Plan

The final Concept Plan for Mitchell Park includes the following elements:

A. Entry Plaza: the entry area to the park is preserved in size, but re-paved in concrete. Upgrades to bike racks, bench, tiny library and entry sign are made to enhance the character, practicality and durability of these elements.

B. Boardwalk: a swale to convey stormwater is introduced along the north and eastern edges of the park. a pedestrian entry boardwalk bridges over the swale creating a small opportunity to provide a special entry sequence into the park (boardwalk complemented by plantings).

C. Native Plantings: along the north boundary of the park, understory planting is introduced to address drainage issues in concert with grading improvements. These new plantings will also present an opportunity to increase habitat capacity and buffer zones.

D. Path: a sweeping entry path provides a more gracious entry access but also decompresses the north boundary allowing more room to address drainage issues generated on this side of the park.

E. Shade Structure: a wood shade structure with a table and chairs provides an inviting and attractive seating area that can be used for parents watching kids play, to picnic or reading.

F. Swings: The swing play structure is replaced and increased from 2 to 4 to accommodate more children playing together.

G. Water Play: a small-footprint mist fountain is introduced within the play area periphery to diversify the play opportunities and provide a cooling element for warm days.

H. Rock Boulders: rock boulders are strung along the north and south edges of the playground to embrace the space and define the accessible surface area. Additionally, these boulders present great opportunities for informal climbing, skipping and jumping. Parents can sit along the edge as they monitor kids' play.

I. Rain Garden: along the south boundary, rain gardens and planted areas are introduced to collect stormwater and allow for infiltration.

J. Shade Trees: new trees are planted as needed to replace old and declining canopy trees.



rain / pollinator garden educational opportunities

bike racks

reading nook + new bench

small entry boardwalk

new park sign

new perimeter canopy

Provide a welcoming space for multiple users with a range of needs including parents with kids, adults, dog walkers.

shade structure + picnic area close to play

low seating stone wall (retain grade)

new low understory planting

4 swings extend rubber play surface north

mister-water play

low seating stone wall (retain grade)

rain garden

LAWN

low maintenance planting



Final Concept

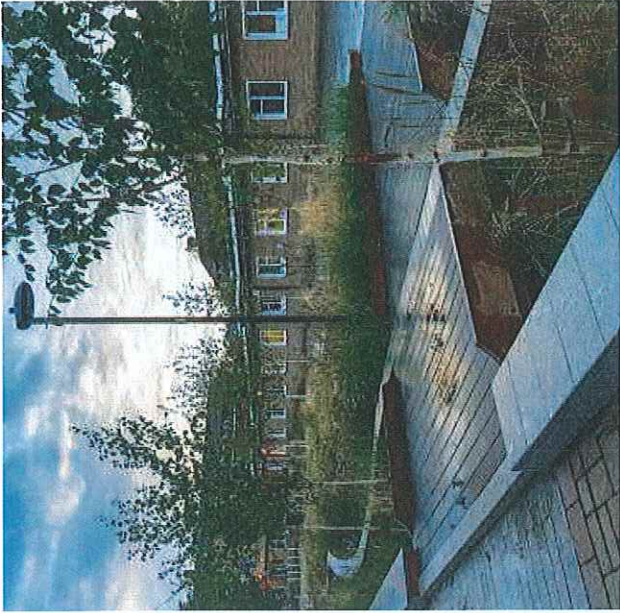
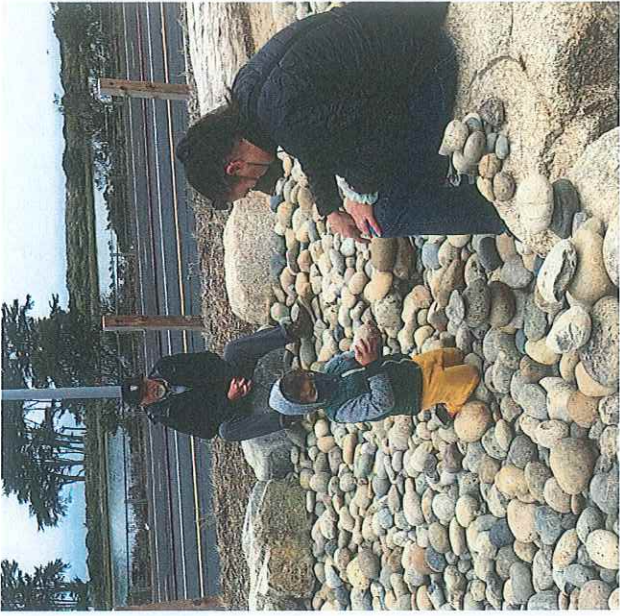



Drainage Diagram

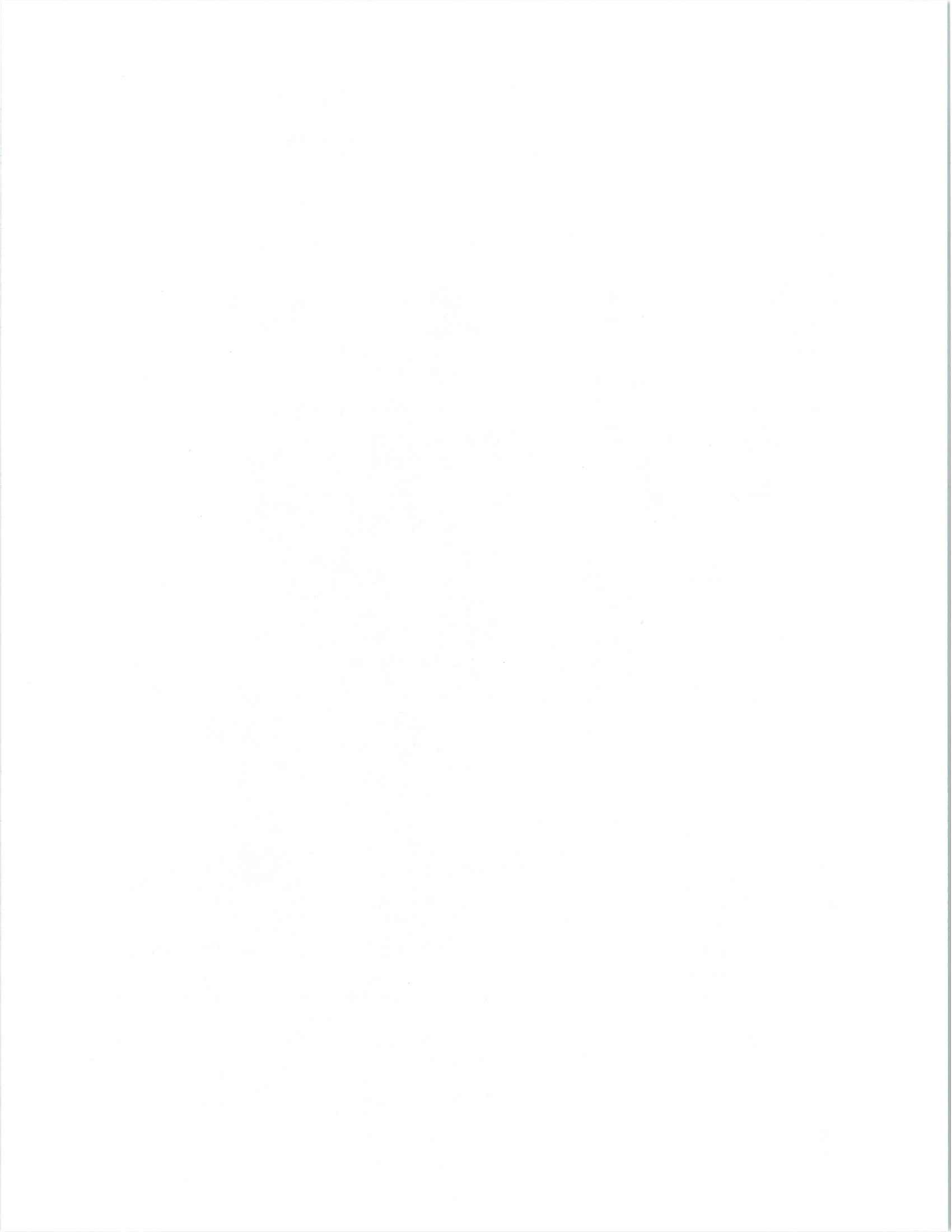

Appendix A

Cost Analysis

Cost Analysis

A broad cost analysis was prepared for the Master Plan to capture value for key park improvements. This cost is based on the final Concept Plan presented in page 18. As the design process progresses with a survey and project budget, the design would need to adjust to respond accordingly to opportunities and limitations.

A. Entry Plaza		
Items Included		Cost
Bike rack, bench, tiny library, park signage, concrete pad, trash receptacle		\$45,500
B. Boardwalk		
Items Included		Cost
Wood bridge with footings		\$15,000
C. Native Plantings		
Items Included		Cost
Soil amendment, grading, plants, mulch		\$19,600
D. Path		
Items Included		Cost
6' wide concrete path		\$15,000
E. Shade Structure*		
Items Included		Cost
Wood shade Structure 12x12, 8' wood picnic table, boulders, accessible surface material, trash receptacle		\$104,000
**Shade Structure Alternative: Larger Shade Structure with Two Picnic Tables, Drinking Fountain and Boulders		\$160,000
F. Swings*		
Items Included		Cost
4-swing play structure, poured-in-place safety surface		\$33,000

G. Water Play*	
Items Included	Cost
Single water mister tower, paved surface, boulders, plumbing	\$92,000
H. Rain Garden	
Items Included	Cost
Understory perennials and shrubs, soil amendment, grading, mulch	\$15,400
I. Shade Trees	
Items Included	Cost
15 Gal. RPM Trees, soil amendment, mulch	\$8,000
Additional Costs and Fees	
Items Included	Cost
General Sitework, excavation + demolition and haul-off, tree removal, irrigation, soil amendments, mobilization	\$20,000
Survey	\$2,500
Design Fees	\$63,500
Sub-Total	
15% Design Contingency	\$55,125
Total	
	\$488,625

*NOTE: Although costs for park improvements are broken down into categories, many of these amenities are interrelated and would need to be built at the same time; therefore, costs would need to be assumed in synchronicity.

Appendix B

Community Input

Q1 Which age range best describe you?

Answered: 53 Skipped: 0

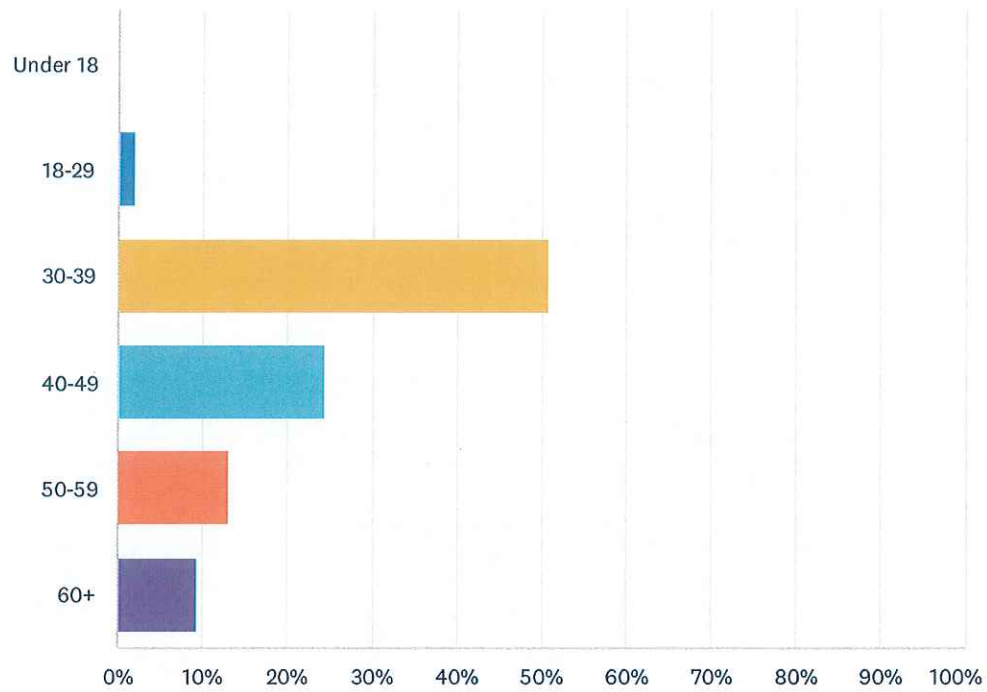

ANSWER CHOICES	RESPONSES	
Under 18	0.00%	0
18-29	1.89%	1
30-39	50.94%	27
40-49	24.53%	13
50-59	13.21%	7
60+	9.43%	5
Total Respondents: 53		

Q2 How often do you visit Mitchell Park?

Answered: 53 Skipped: 0

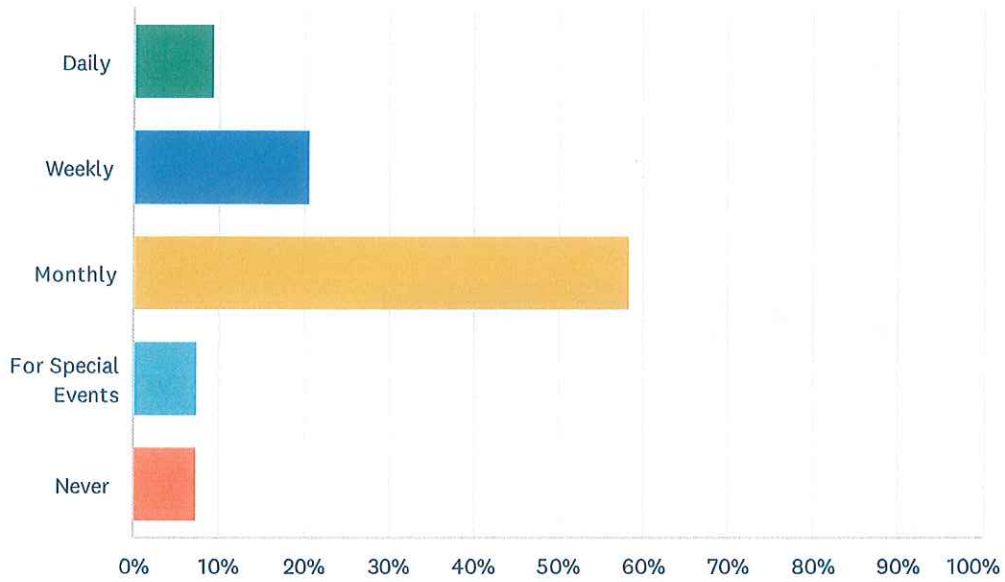

ANSWER CHOICES	RESPONSES	
Daily	9.43%	5
Weekly	20.75%	11
Monthly	58.49%	31
For Special Events	7.55%	4
Never	7.55%	4
Total Respondents: 53		

Q3 When you go to Mitchell Park, what activities do you typically do?

Answered: 52 Skipped: 1

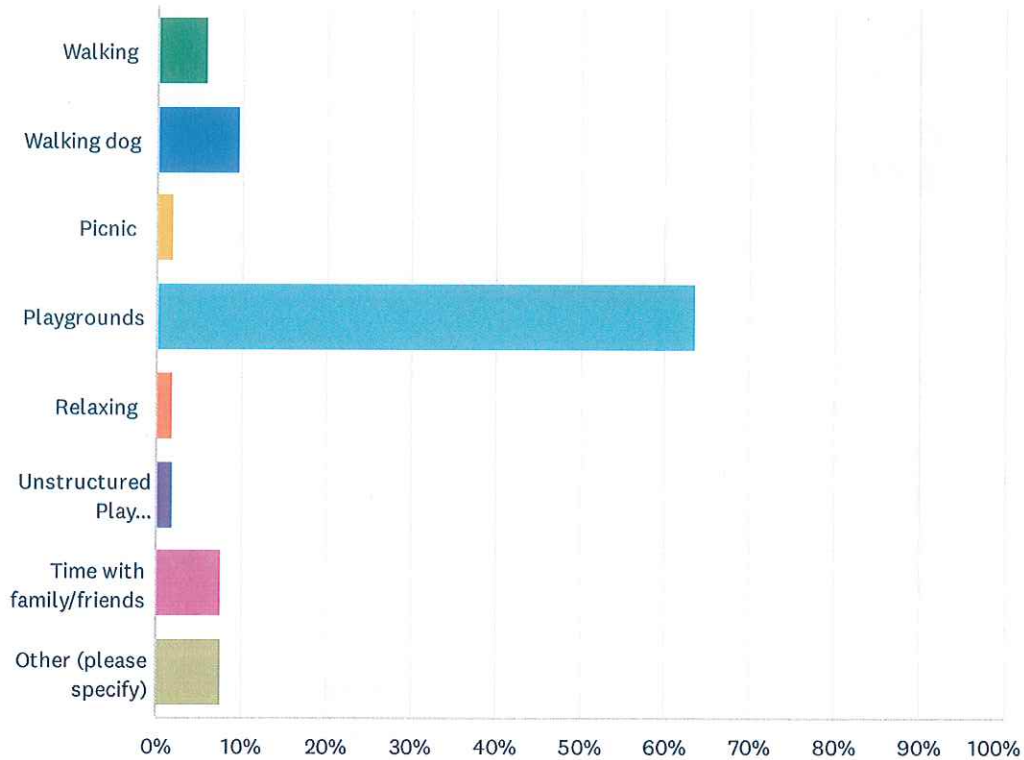

ANSWER CHOICES	RESPONSES	
Walking	5.77%	3
Walking dog	9.62%	5
Picnic	1.92%	1
Playgrounds	63.46%	33
Relaxing	1.92%	1
Unstructured Play (non-playground)	1.92%	1
Time with family/friends	7.69%	4
Other (please specify)	7.69%	4
TOTAL		52

#	OTHER (PLEASE SPECIFY)	DATE
1	Bring my preschoolers from KECC ages 3-5	3/29/2023 11:16 AM
2	It is directly across the street from me so more often than not it is simply to pick up trash. Also I get to look at it and sometimes deal with parking issues.	3/27/2023 3:40 PM
3	Actually all of the above	3/24/2023 3:02 PM

Q4 Do you feel additional swings are needed? What kind of swings do you like?

Answered: 50 Skipped: 3

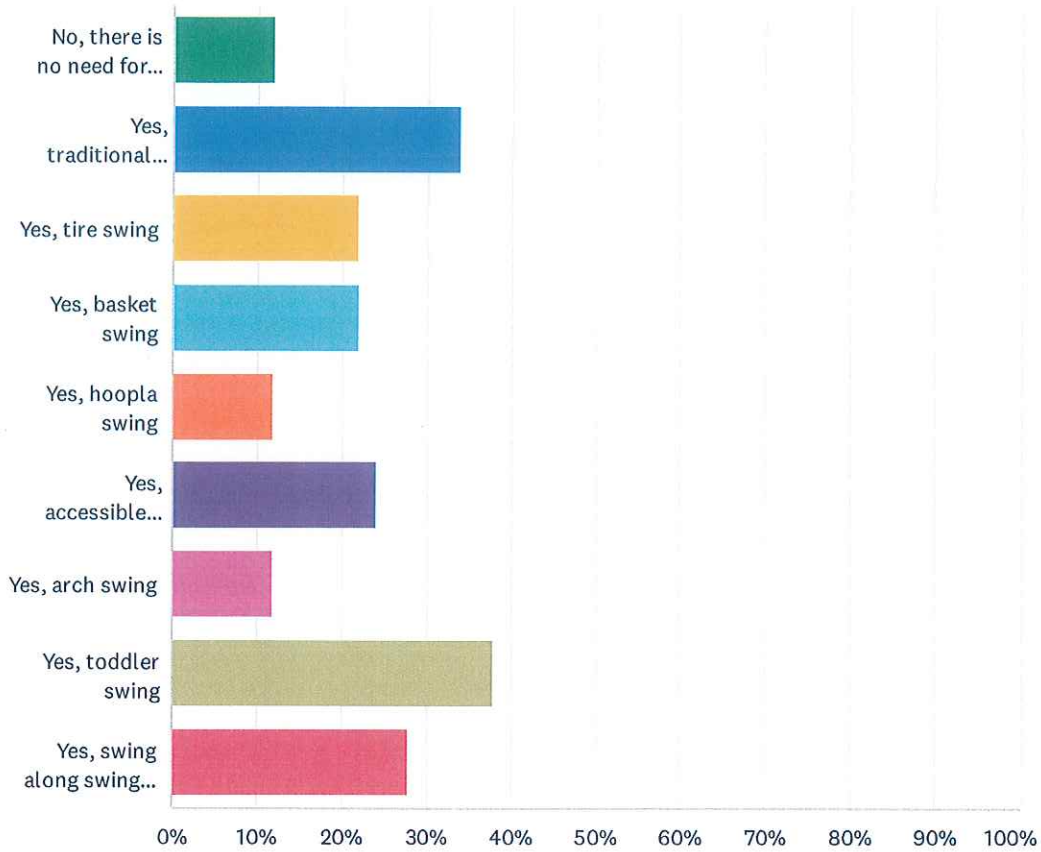

ANSWER CHOICES	RESPONSES	
No, there is no need for additional swings.	12.00%	6
Yes, traditional belt swings	34.00%	17
Yes, tire swing	22.00%	11
Yes, basket swing	22.00%	11
Yes, hoopla swing	12.00%	6
Yes, accessible swing	24.00%	12
Yes, arch swing	12.00%	6
Yes, toddler swing	38.00%	19
Yes, swing along swing seats	28.00%	14
Total Respondents: 50		

Q5 What new/ updated amenities would you like to see most in Mitchell Park? (Vote for your top 3 choices)

Answered: 53 Skipped: 0

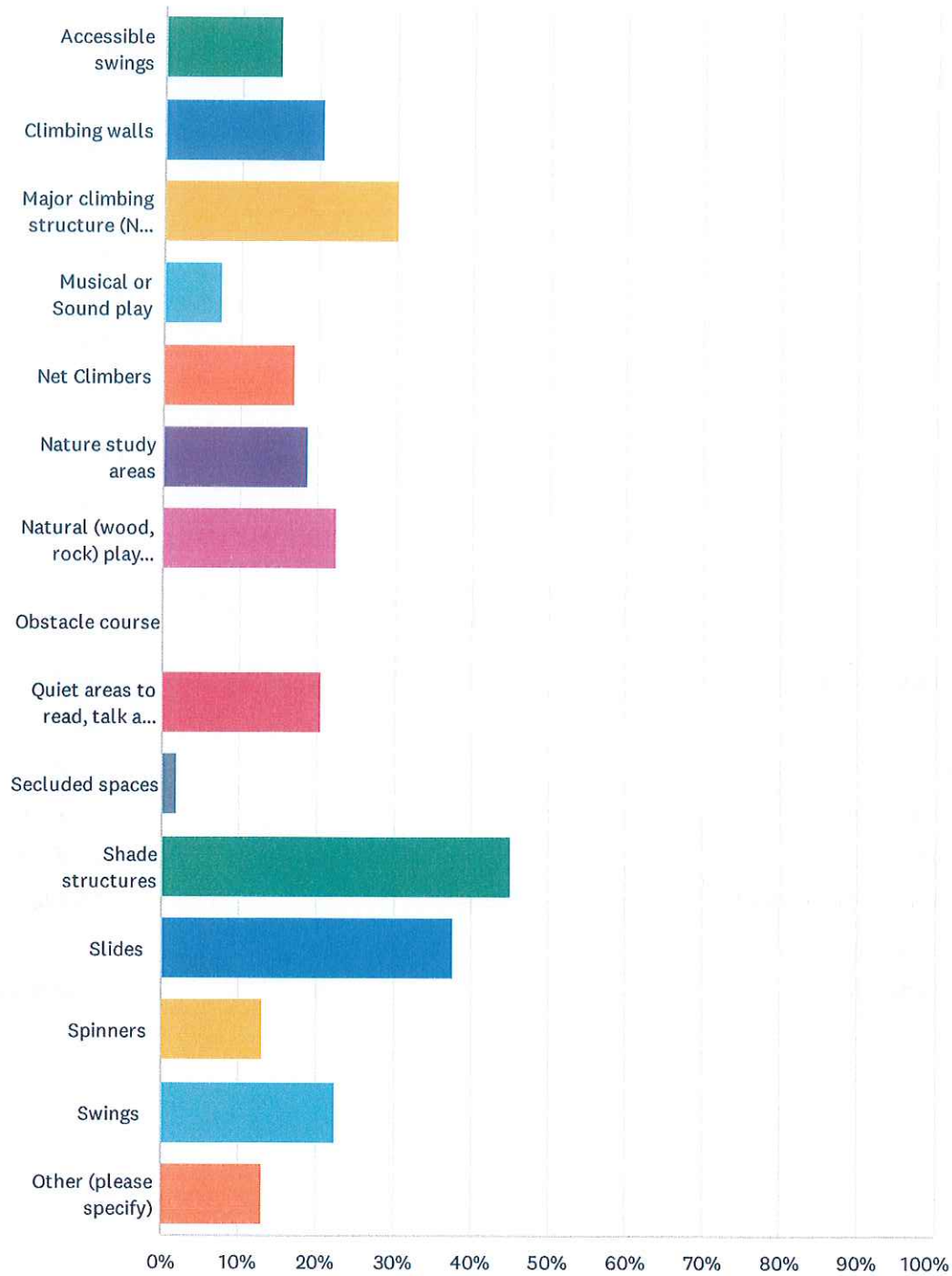

ANSWER CHOICES	RESPONSES	
Accessible swings	15.09%	8
Climbing walls	20.75%	11
Major climbing structure (New or refurbishing the current one)	30.19%	16
Musical or Sound play	7.55%	4
Net Climbers	16.98%	9
Nature study areas	18.87%	10
Natural (wood, rock) play pieces	22.64%	12
Obstacle course	0.00%	0
Quiet areas to read, talk and relax	20.75%	11
Secluded spaces	1.89%	1
Shade structures	45.28%	24
Slides	37.74%	20
Spinners	13.21%	7
Swings	22.64%	12
Other (please specify)	13.21%	7
Total Respondents: 53		

#	OTHER (PLEASE SPECIFY)	DATE
1	Bathrooms!!	3/29/2023 9:56 PM
2	Bathrooms	3/29/2023 9:25 PM
3	Nothing else is needed	3/29/2023 9:25 PM
4	Monkey bars	3/29/2023 5:23 PM
5	A climber that is safer than the big one. Drop zones are scary.	3/29/2023 11:16 AM
6	Open space for free play	3/27/2023 3:40 PM
7	misting water feature	3/24/2023 6:13 AM

Q6 What Education and Nature Play would you like to see most in Mitchell Park?

Answered: 51 Skipped: 2

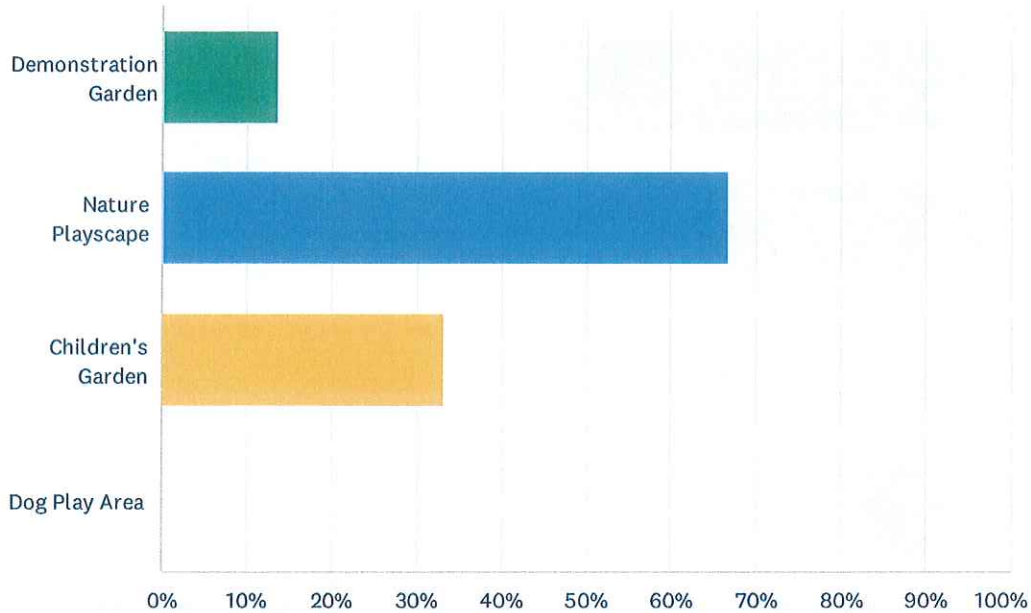

ANSWER CHOICES	RESPONSES	
Demonstration Garden	13.73%	7
Nature Playscape	66.67%	34
Children's Garden	33.33%	17
Dog Play Area	0.00%	0
Total Respondents: 51		

#	ANYTHING ELSE?	DATE
1	within the prairie garden	4/5/2023 7:42 PM
2	Bathrooms	3/29/2023 9:56 PM
3	Some type of low fencing to enclose Park areas, keep kids away from street, neighbors property.	3/29/2023 11:16 AM
4	None. Open green space	3/27/2023 3:40 PM

Q7 What kind of stormwater enhancements would you like to see in Mitchell Park?

Answered: 42 Skipped: 11

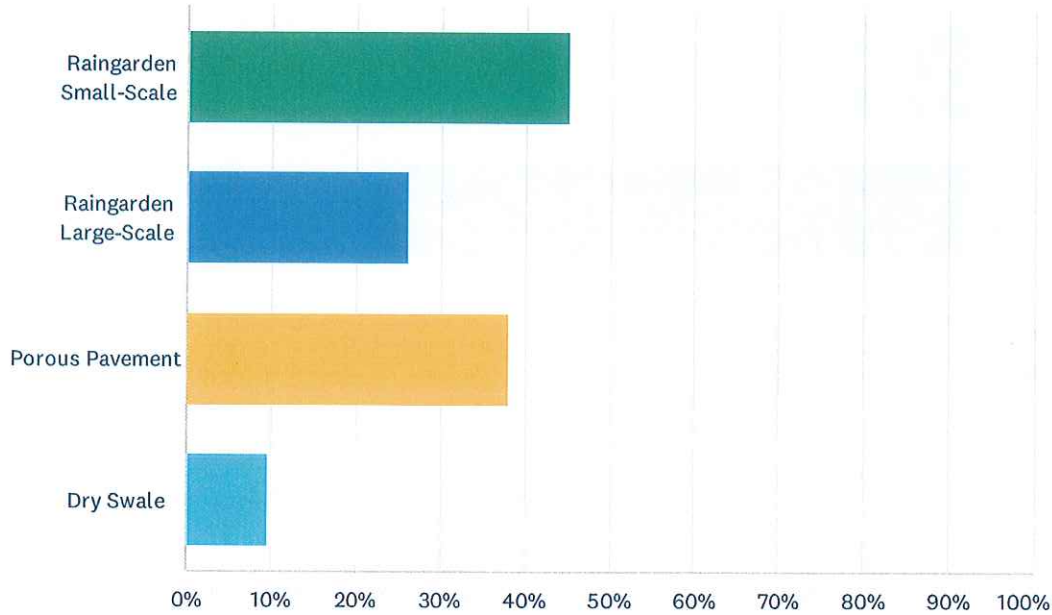

ANSWER CHOICES	RESPONSES
Raingarden Small-Scale	45.24% 19
Raingarden Large-Scale	26.19% 11
Porous Pavement	38.10% 16
Dry Swale	9.52% 4
Total Respondents: 42	

#	ANYTHING ELSE?	DATE
1	The grass can already get super wet!!! Whatever to help drain	3/29/2023 10:33 PM
2	anything to stop the water from traveling into the neighboring property	3/29/2023 11:08 AM
3	I don't see much of a storm water issue there.	3/24/2023 3:02 PM

Q8 What kind of Native Plant Biodiversity Enhancements would you like to see in Mitchell Park?

Answered: 41 Skipped: 12

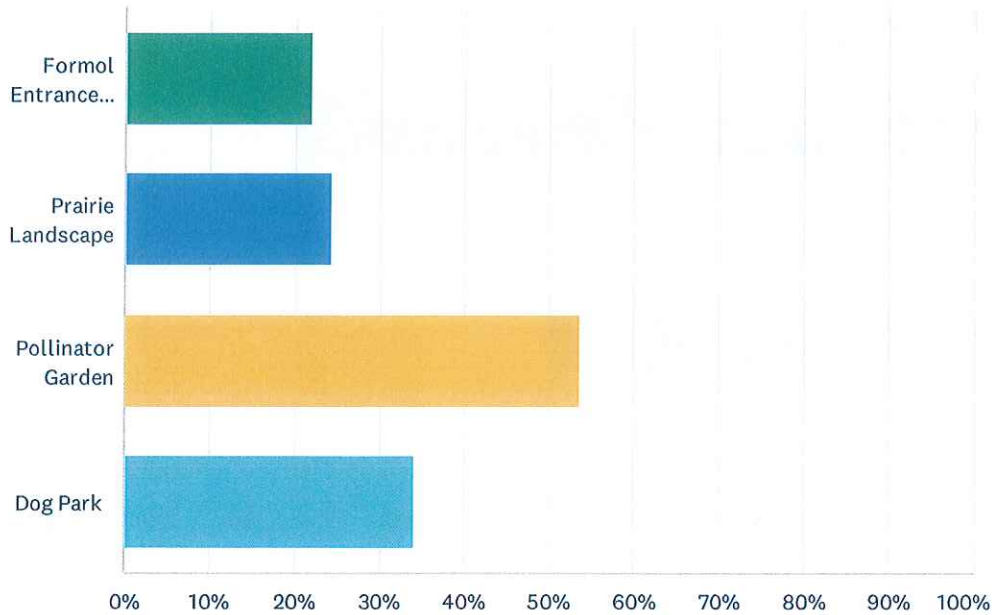

ANSWER CHOICES	RESPONSES	
Formol Entrance Gardens	21.95%	9
Prairie Landscape	24.39%	10
Pollinator Garden	53.66%	22
Dog Park	34.15%	14
Total Respondents: 41		

#	ANYTHING ELSE?	DATE
1	no to dog park!	4/5/2023 7:42 PM
2	Splash pad	3/29/2023 9:56 PM
3	No dog park!	3/29/2023 12:24 PM
4	No bushes with berries- the kind that are currently there drop red berries that are appealing to toddlers	3/29/2023 11:34 AM
5	No dogs!! Too much litter(poop) not good for kids.	3/29/2023 11:16 AM
6	Grass	3/27/2023 3:40 PM

Q9 What play surface would you like to play on?

Answered: 47 Skipped: 6

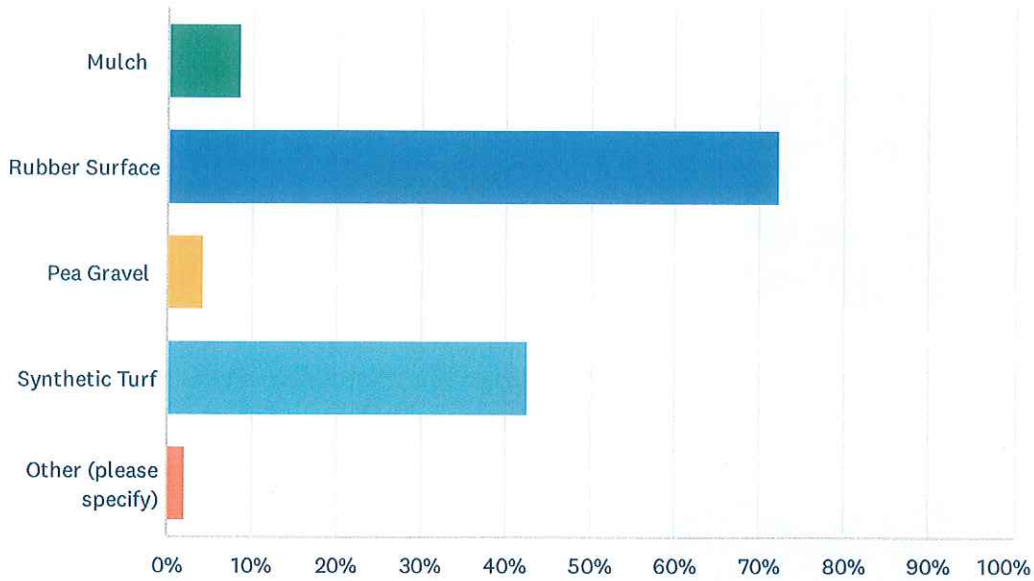

ANSWER CHOICES	RESPONSES	
Mulch	8.51%	4
Rubber Surface	72.34%	34
Pea Gravel	4.26%	2
Synthetic Turf	42.55%	20
Other (please specify)	2.13%	1
Total Respondents: 47		

#	OTHER (PLEASE SPECIFY)	DATE
1	The area can get and stay we so anything that doesn't hold the water otherwise it'll be a huge mess	3/29/2023 10:33 PM

Q10 What type of shaded picnic structure would you like to see?

Answered: 41 Skipped: 12

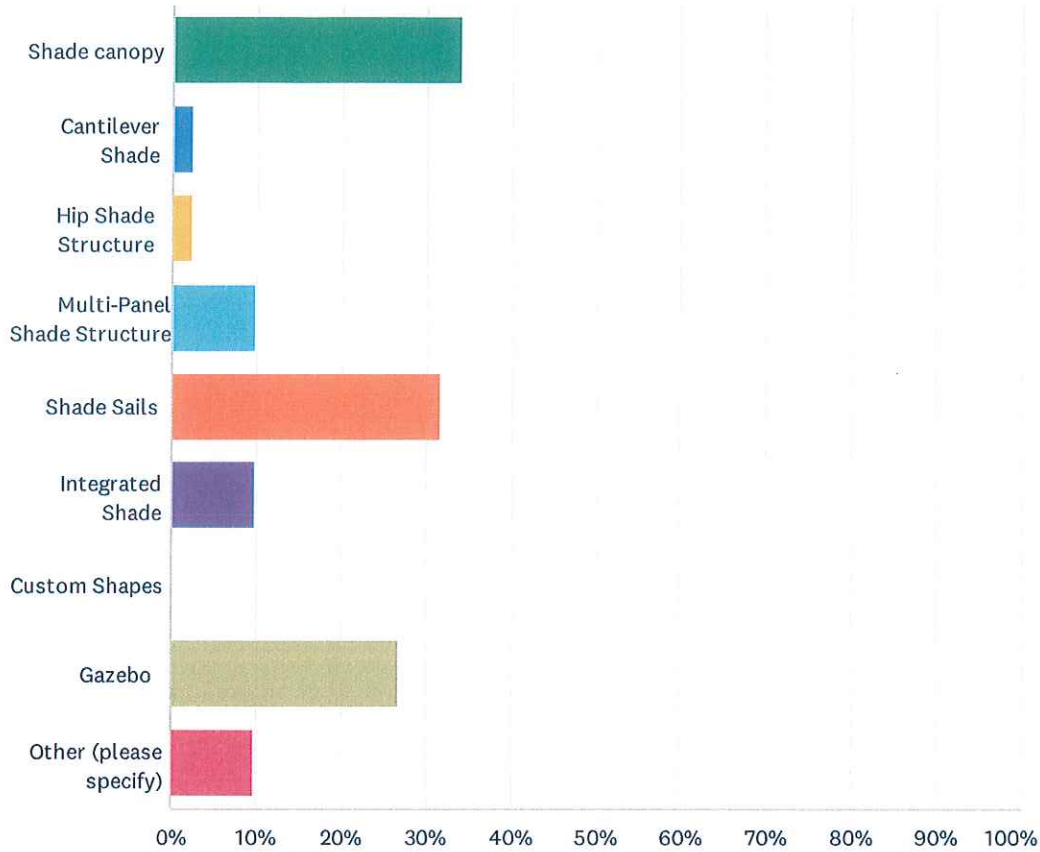

ANSWER CHOICES	RESPONSES	
Shade canopy	34.15%	14
Cantilever Shade	2.44%	1
Hip Shade Structure	2.44%	1
Multi-Panel Shade Structure	9.76%	4
Shade Sails	31.71%	13
Integrated Shade	9.76%	4
Custom Shapes	0.00%	0
Gazebo	26.83%	11
Other (please specify)	9.76%	4
Total Respondents: 41		

#	OTHER (PLEASE SPECIFY)	DATE
1	Idk what these diffetoptions are but shade over some benches and the play structure would be	3/30/2023 4:22 AM

great!!

2	I prefer more trees and not a gazebo or structure	3/29/2023 9:25 PM
3	Not sure specifically but I think adding shade is a great idea	3/29/2023 12:24 PM
4	People might not know what all of the above shade structure options look like. Something that offers children to play under shade or a space that is shaded for caregivers to be while also watching children on play equipment.	3/29/2023 12:11 PM

Q11 What type of water play element would you like to see?

Answered: 40 Skipped: 13

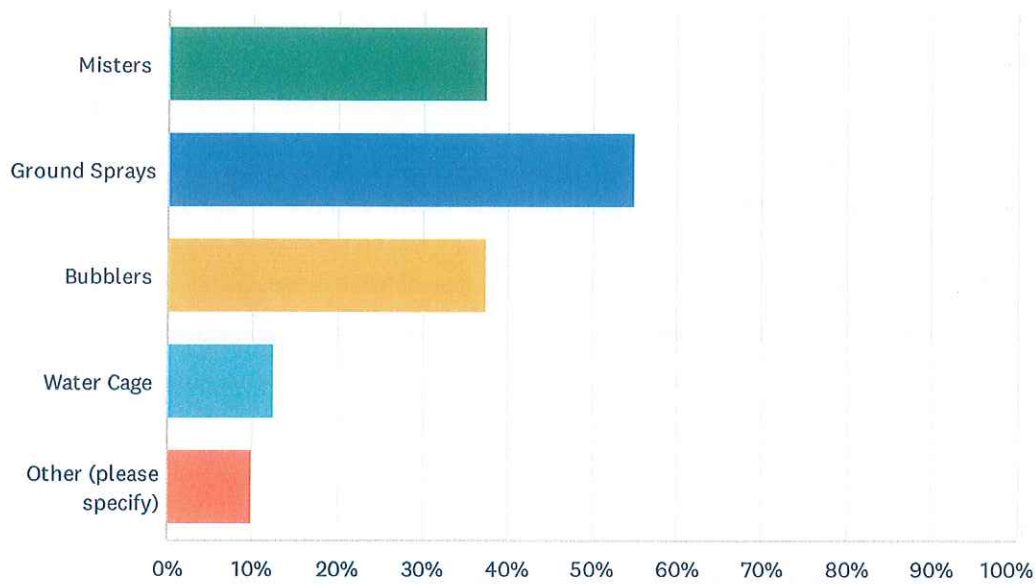

ANSWER CHOICES	RESPONSES	
Misters	37.50%	15
Ground Sprays	55.00%	22
Bubblers	37.50%	15
Water Cage	12.50%	5
Other (please specify)	10.00%	4
Total Respondents: 40		

#	OTHER (PLEASE SPECIFY)	DATE
1	none	4/5/2023 7:42 PM
2	None	3/29/2023 9:25 PM
3	Creek/pump flow	3/29/2023 11:34 AM
4	None	3/27/2023 3:40 PM

Q12 What keeps you from using Mitchell Playground/ Park?

Answered: 21 Skipped: 32

#	RESPONSES	DATE
1	Water fountain	3/31/2023 11:26 PM
2	Not enough for all my kids ages	3/30/2023 10:19 AM
3	My kids don't like that weird loop bridge thing. They'd rather go to a park we have to drive to than walk to Mitchell.	3/30/2023 9:50 AM
4	We would come more often if it was fenced in or at least some type of fence at the street	3/30/2023 4:22 AM
5	My kids love to play sports there but the field is always so wet. Better drainage is a must!	3/29/2023 10:14 PM
6	no bathroom!	3/29/2023 10:07 PM
7	Poor weather	3/29/2023 9:59 PM
8	No bathrooms	3/29/2023 9:56 PM
9	Lack of bathroom	3/29/2023 9:25 PM
10	Parking is tight and there needs to be more available green space for kids to run around	3/29/2023 9:25 PM
11	Not enough things to play on and geared towards younger kids like toddler age. A little bit older kids need some play as well.	3/29/2023 7:56 PM
12	Never heard of it & I live in Kirkwood!	3/29/2023 2:40 PM
13	It is small. Playground equipment (the larger structure) is not ideal for very young children.	3/29/2023 12:11 PM
14	No parking, my kids are older than toddlers	3/29/2023 11:34 AM
15	Grass not cut, mosquitoes	3/29/2023 11:16 AM
16	Bathrooms	3/29/2023 11:11 AM
17	the house at the corner of Jefferson & Mitchell has created a serious water run off issue. the grassy area in front of the park is like a lake after it rains. it collects & keeps water and then it easily runs into the house on the other side of the park.	3/29/2023 11:08 AM
18	Distance from home - not completely walkable	3/29/2023 8:04 AM
19	Playground is very small.	3/28/2023 5:06 PM
20	Nothing	3/27/2023 3:40 PM
21	Nothing!	3/24/2023 3:02 PM

Q13 What do you hope to see accomplished as an outcome of this project?

Answered: 18 Skipped: 35

#	RESPONSES	DATE
1	more user friendly	4/5/2023 7:42 PM
2	New water fountain, maybe with a dog bowl attachment	3/31/2023 11:26 PM
3	Play for ages 1+	3/30/2023 10:19 AM
4	I think the park is great already. I was surprised to see that updating the play structure is an option. I think shade and fencing would be really helpful. If there was some type of splash pad too that would be really fun!	3/30/2023 4:22 AM
5	Increased park usage, improved stormwater draining	3/29/2023 10:59 PM
6	That the area can accommodate an age range of kids within a family :) the last improvement was awesome! As my bigger kids were outgrowing the little part but the little part still was the best thing for the youngest.	3/29/2023 10:33 PM
7	Updated playgrounds and landscaping	3/29/2023 9:59 PM
8	Drainage fixed	3/29/2023 9:25 PM
9	A more updated park and inviting for the neighborhood	3/29/2023 7:56 PM
10	It would be really cool to have a native plant/pollinator garden.	3/29/2023 12:24 PM
11	More inclusive	3/29/2023 11:16 AM
12	Accessibility	3/29/2023 11:11 AM
13	this is a park nestled among several houses. do not add anything else that makes noise. there is currently a LOUD bell that affects the quiet enjoyment of those who live there.	3/29/2023 11:08 AM
14	More/bigger playground	3/29/2023 8:04 AM
15	More visits	3/29/2023 6:15 AM
16	Keep it as simple and open as possible.	3/27/2023 3:40 PM
17	I actually like it the way it already is. A nice quiet place to take the grandkids. I am a volunteer educator at the Litzinger Road Ecology Center (part of MO Botanical Garden) so I always like outdoor education of any sort	3/24/2023 3:02 PM
18	donor and user satisfaction feature upgrade	3/24/2023 6:13 AM

Q14 Anything else you would like to include?

Answered: 13 Skipped: 40

#	RESPONSES	DATE
1	Water fountain	3/31/2023 11:26 PM
2	We love Mitchell park! We like that there is a little kid and big kid area for our multi-age family! The small size of the park is great and we love that we can walk there to play.	3/30/2023 7:04 AM
3	No dog park please. If it's turned into a dog attraction we would not attend at all.	3/30/2023 4:22 AM
4	Bathrooms and splash pad	3/29/2023 9:56 PM
5	We go to Mitchell Park weekly and it is perfect for our two year old.	3/29/2023 7:55 PM
6	We love Mitchell Park and go here all the time. I think its small size is more attractive to families with very young children so please include some features for little ones -- like the toddler swing that is there currently. We love to come here after school and burn off a little energy so we really enjoy the climbing/play structures. I prefer this not become a "dog park" or especially dog friendly space as I feel like there are other places in kirkwood for people to go with their dogs. My little kids are not comfortable around other dogs so if we knew there were dogs, especially off leash, we would not come	3/29/2023 12:24 PM
7	Some options listed to select from in this survey are not explained well.	3/29/2023 12:11 PM
8	Thank you for doing this!	3/29/2023 11:16 AM
9	trees, plants, shrubs...anything to help soak up the rainwater run off.	3/29/2023 11:08 AM
10	Bathroom	3/28/2023 8:45 PM
11	Please don't clutter this tiny gem up with construction and especially no fence around it. Also too many things in it will draw even more cars and there is no significant parking available.	3/27/2023 3:40 PM
12	Thanks for taking good care of this nice place	3/24/2023 3:02 PM
13	corrective drainage measures to keep water and mud from running on play/walking surfaces	3/24/2023 6:13 AM

Q15 Contact Information

Answered: 32 Skipped: 21

ANSWER CHOICES	RESPONSES	
Name	100.00%	32
Company	0.00%	0
Address	90.63%	29
Address 2	0.00%	0
City/Town	84.38%	27
State/Province	0.00%	0
ZIP/Postal Code	100.00%	32
Country	0.00%	0
Email Address	87.50%	28
Phone Number	0.00%	0

#	NAME	DATE
1	Kathy Paulsen	4/5/2023 7:42 PM
2	Charlie	3/31/2023 11:26 PM
3	Erin Wendling	3/30/2023 7:05 PM
4	Claire Pupillo	3/30/2023 10:19 AM
5	Andrew Jacobson	3/30/2023 9:50 AM
6	Jamie Oeltjen	3/30/2023 7:04 AM
7	erika burke	3/30/2023 4:22 AM
8	Mike Truax	3/29/2023 10:59 PM
9	Anna Vatterott	3/29/2023 10:33 PM
10	Stephanie Keller	3/29/2023 10:14 PM
11	lauren cappell	3/29/2023 10:07 PM
12	Lauren Schnitzler	3/29/2023 9:59 PM
13	Heather Jacobson	3/29/2023 9:56 PM
14	Deb Ehrstein	3/29/2023 9:25 PM
15	Renee	3/29/2023 7:56 PM
16	Natalie Woods	3/29/2023 7:55 PM
17	Lois McSwain	3/29/2023 2:40 PM
18	Caroline	3/29/2023 12:24 PM
19	MaryEllen	3/29/2023 12:11 PM
20	Aimee	3/29/2023 11:38 AM

21	Kristin Morris	3/29/2023 11:08 AM
22	Dane	3/29/2023 11:00 AM
23	Megan Meadows	3/29/2023 10:56 AM
24	Julie Sonn	3/29/2023 8:04 AM
25	Megan brady	3/29/2023 6:15 AM
26	Rani Grady	3/28/2023 8:45 PM
27	Catherine B	3/28/2023 4:27 PM
28	Abby Katz	3/28/2023 3:40 PM
29	Renee Werner	3/27/2023 4:58 PM
30	Steve Ehrstein	3/27/2023 3:40 PM
31	Diane Gorman	3/24/2023 3:02 PM
32	Curtis Carron	3/24/2023 6:13 AM

#	COMPANY	DATE
	There are no responses.	

#	ADDRESS	DATE
1	401 Frieda Ave	4/5/2023 7:42 PM
2	106 Mitchell Street	3/31/2023 11:26 PM
3	440 Magnolia Avenue	3/30/2023 7:05 PM
4	521 Venneman Ave	3/30/2023 10:19 AM
5	15 Armstrong	3/30/2023 9:50 AM
6	62 Armstrong Drive	3/30/2023 7:04 AM
7	801 Doerwood Court	3/30/2023 4:22 AM
8	620 East Jefferson Ave	3/29/2023 10:59 PM
9	656 e Jefferson Ave	3/29/2023 10:33 PM
10	202 N Holmes	3/29/2023 10:14 PM
11	616 windrush drive	3/29/2023 10:07 PM
12	847 Victoria Pl	3/29/2023 9:59 PM
13	15 Armstrong Dr 63122	3/29/2023 9:56 PM
14	112 Mitchell Street	3/29/2023 9:25 PM
15	102 Handlan Ct	3/29/2023 7:56 PM
16	657 Hawbrook Ave	3/29/2023 7:55 PM
17	701 West Woodbine	3/29/2023 2:40 PM
18	126 n Woodlawn	3/29/2023 11:38 AM
19	109 Mitchell	3/29/2023 11:08 AM
20	611 maple Frst	3/29/2023 11:00 AM
21	6 Adams Lane	3/29/2023 10:56 AM
22	934 Quanal Ct	3/29/2023 8:04 AM
23	7 Schultz Rd	3/28/2023 8:45 PM

24	1207 North Geyer Rd	3/28/2023 4:27 PM
25	521 Scott Ave	3/28/2023 3:40 PM
26	110 Mitchell	3/27/2023 4:58 PM
27	112 Mitchell	3/27/2023 3:40 PM
28	505 E. Argonne	3/24/2023 3:02 PM
29	111 S. Geyer Road	3/24/2023 6:13 AM

#	ADDRESS 2	DATE
There are no responses.		

#	CITY/TOWN	DATE
1	Kirkwood	4/5/2023 7:42 PM
2	Kirkwood	3/31/2023 11:26 PM
3	Kirkwood	3/30/2023 7:05 PM
4	Glendale	3/30/2023 10:19 AM
5	Glendale	3/30/2023 7:04 AM
6	Kirkwood	3/30/2023 4:22 AM
7	Kirkwood	3/29/2023 10:59 PM
8	St. Louis	3/29/2023 10:33 PM
9	kirkwood	3/29/2023 10:07 PM
10	St Louis	3/29/2023 9:59 PM
11	Saint louis	3/29/2023 9:56 PM
12	Saint Louis	3/29/2023 9:25 PM
13	Kirkwood	3/29/2023 7:56 PM
14	Kirkwood	3/29/2023 2:40 PM
15	Kirkwood	3/29/2023 12:11 PM
16	Kirkwood	3/29/2023 11:08 AM
17	Kirkwood	3/29/2023 11:00 AM
18	Kirkwood	3/29/2023 10:56 AM
19	Kirkwood	3/29/2023 8:04 AM
20	Kirkwood	3/29/2023 6:15 AM
21	Saint Louis	3/28/2023 8:45 PM
22	Kirkwood	3/28/2023 4:27 PM
23	Kirkwood	3/28/2023 3:40 PM
24	Kirkwood	3/27/2023 4:58 PM
25	Kirkwood	3/27/2023 3:40 PM
26	Kirkwood	3/24/2023 3:02 PM
27	Kirkwood	3/24/2023 6:13 AM

#	STATE/PROVINCE	DATE
There are no responses.		

#	ZIP/POSTAL CODE	DATE
---	-----------------	------

1	63122	4/5/2023 7:42 PM
2	63122	3/31/2023 11:26 PM
3	63122	3/30/2023 7:05 PM
4	63122	3/30/2023 10:19 AM
5	63122	3/30/2023 9:50 AM
6	63122	3/30/2023 7:04 AM
7	63122	3/30/2023 4:22 AM
8	MO	3/29/2023 10:59 PM
9	63122	3/29/2023 10:33 PM
10	63122	3/29/2023 10:14 PM
11	63122	3/29/2023 10:07 PM
12	63122	3/29/2023 9:59 PM
13	63122	3/29/2023 9:56 PM
14	63122	3/29/2023 9:25 PM
15	63122	3/29/2023 7:56 PM
16	63122	3/29/2023 7:55 PM
17	63122	3/29/2023 2:40 PM
18	63122	3/29/2023 12:24 PM
19	63122	3/29/2023 12:11 PM
20	63122	3/29/2023 11:38 AM
21	63122	3/29/2023 11:08 AM
22	63122	3/29/2023 11:00 AM
23	63122	3/29/2023 10:56 AM
24	63122	3/29/2023 8:04 AM
25	63122	3/29/2023 6:15 AM
26	63122	3/28/2023 8:45 PM
27	63122	3/28/2023 4:27 PM
28	63122	3/28/2023 3:40 PM
29	63122	3/27/2023 4:58 PM
30	63122	3/27/2023 3:40 PM
31	63122	3/24/2023 3:02 PM
32	63122	3/24/2023 6:13 AM
#	COUNTRY	DATE
	There are no responses.	
#	EMAIL ADDRESS	DATE
1	Paulsen_63122@sbcglobal.net	4/5/2023 7:42 PM
2	crk19999@gmail.com	3/31/2023 11:26 PM
3	egibbs88@gmail.com	3/30/2023 7:05 PM

4	claire.pupillo@gmail.com	3/30/2023 10:19 AM
5	jamie.oeltjen@gmail.com	3/30/2023 7:04 AM
6	erikaloudenslager@gmail.com	3/30/2023 4:22 AM
7	63122	3/29/2023 10:59 PM
8	annavatterott@yahoo.com	3/29/2023 10:33 PM
9	lcmcdonell@gmail.com	3/29/2023 10:07 PM
10	laurend875@yahoo.com	3/29/2023 9:59 PM
11	heathernjacobson@gmail.com	3/29/2023 9:56 PM
12	debehrstein@gmail.com	3/29/2023 9:25 PM
13	oleary32@me.com	3/29/2023 7:56 PM
14	natshoults@gmail.com	3/29/2023 7:55 PM
15	sscmglois@att.net	3/29/2023 2:40 PM
16	cms4ca@gmail.com	3/29/2023 12:24 PM
17	maryellen.petrie@gmail.com	3/29/2023 12:11 PM
18	aimee.schlanger@gmail.com	3/29/2023 11:38 AM
19	klam6@hotmail.com	3/29/2023 11:08 AM
20	dane.anderson@gmail.com	3/29/2023 11:00 AM
21	garciajulieelise@gmail.com	3/29/2023 8:04 AM
22	rani.grady@gmail.com	3/28/2023 8:45 PM
23	czaegel1@gmail.com	3/28/2023 4:27 PM
24	abbykatz929@gmail.com	3/28/2023 3:40 PM
25	kosma693@gmail.com	3/27/2023 4:58 PM
26	steveehrstein@gmail.com	3/27/2023 3:40 PM
27	the_gormans@msn.com	3/24/2023 3:02 PM
28	carroncr@kirkwoodmo.org	3/24/2023 6:13 AM
#	PHONE NUMBER	DATE
	There are no responses.	

DRINKING
FOUNTAIN
FOR PEOPLE
& DOGS

walls
scattered around
for better tag

sculpture for
climbing

mini-stream
for water
play that runs
along path

mini-zipline

Tunnel slide from
top level →

Climbing themed
element →
Playground
Should be more
dangerous

Please Add

A doggie Poo
Bag dispenser

climbing rocks



~~Tube~~
playground

Train themed
element



sauser
swing



Circular walking
path on the
South side of
the park



climbing
tree



fix the
benches



~~A~~ Some
Kind of
shade over
Play structures



~~other~~
playground
section

